



21 W. Nicolet St.
Banning, CA 92220
(951) 849-3192 (tel.)
(951) 849-6355 (fax)
www.banninglibrarydistrict.org

Regular Board Meeting Agenda

December 9, 2020

5:00 p.m.

Children's Room & Zoom

In an effort to protect public health and prevent the spread of COVID-19, the Banning Library District board meeting will not be open to the public. The Banning Library District encourages the public to call via teleconference at: <https://tinyurl.com/reg12920> (Passcode: 094365). Members of the public who wish to comment on matters before the Board may submit comments on or before 3 pm, Wednesday, December 9, 2020 to christian@banninglibrarydistrict.org. Any comments received will be read and must still be limited to 5 minutes.

Americans with Disabilities Act Compliance: If you need special assistance to participate in this meeting, please contact the administration office at (951) 849-3192 at least 72 hours prior to the meeting.

Public Requests for Documents: The District provides a public inspection copy of all materials included in the agenda packet distributed to the Board members. Members of the public who wish to obtain a copy of any document may do so by completing a Request for Public Document form and submitting it to the Administration who will arrange for the documents to be copied at a charge of 10¢ per page. Request forms are available at the District Administration offices.

1. **Call to Order, Pledge of Allegiance, Roll Call**

2. **Adoption of Agenda**

3. **Public Comment**

Individuals may address the Board regarding any item of Library District business on or not on the agenda. Comments are limited to 5 minutes per person. While all comments are welcome, the Brown Act does not allow the Board to take action on any item not on the agenda. Please complete the "Request to Address the Board" card by filling out your name and the specific item you wish to address.

4. **Closed Session**

4.1 Public Employee Performance Evaluation – District Director
Pursuant to Government Code Section 54957

5. **Consent Calendar**

All Consent Calendar items will be acted upon a single action of the Board unless otherwise requested by an individual Board Member for separate consideration.

Recommended Action: The Board of Trustees hereby approves the items below:

5.1 Minutes of the Regular Board meeting—November 18, 2020

6. **Consideration of Items Removed from the Consent Calendar**

Items removed from the Consent Calendar will be discussed individually at this time.

7. **Finance Report**

8. **District Director's Report**

9. **Board Reports and Comments**

Board members are encouraged to report on items of information not requiring comment or discussion to the entire body at this time. (Reference: The Ralph M. Brown Act)

10. **Unfinished Business**

11. **New Business**

11.1 Oath of Office – Board Trustees

11.2 Authorize the Director to enter into an Agreement with Vector USA for Network Design and Implementation in the amount of \$99,354.80 – (grant award)

11.3 Authorize the Director to enter into an Agreement for drywall or lath/plaster work services in the amount not to exceed \$4,350

11.4 Compensation Study Final Reports and Recommendations

11.5 Amendments to Policy No. 5220 Internet, E-mail, and Electronic Communication Ethics, Usage and Security

11.6 Amendments to Policy No. 5330 Separation from District Employment

12. **Last Minute Action Items**

The Board may discuss an item, which was not previously placed on the agenda when the Board determines that there is a need for immediate action which cannot reasonably wait for the next regularly scheduled meeting. The determination must be made by two-thirds of the total Board or, if two-thirds of the Board is no present, by a unanimous vote of those remaining. (Reference: The Ralph M. Brown Act)

13. **Agenda Items for Future Agendas**

14. **Next Regular Board Meeting**

January 13, 2021

15. **Adjournment**



21 W. Nicolet St.
Banning, CA 92220
(951) 849-3192 (tel.)
(951) 849-6355 (fax)

www.banninglibrarydistrict.org

MINUTES

REGULAR MEETING OF THE BOARD OF TRUSTEES

November 18, 2020 | 5:00 P.M. | Teen Room (Zoom Virtual Meeting)

CALL TO ORDER, PLEDGE OF ALLEGIANCE, ROLL CALL

President Little called the Regular Meeting of the Banning Library District Board of Trustees to order on November 18, 2020 at 5:04 p.m.

Members Present: President Kathy Little, Secretary Alejandro Geronimo, Trustee Wemida Ajigbotafe, Trustee Melanie Lara and Trustee Loretta Cousar.

Members Absent: None.

Staff Present: Kevin Lee, District Director; Fernando Morales, Circulation Manager and Christian Tzintzun, Library Assistant.

Guests: Linda Page, Gae Rusk, Nit Bowden, and Tanya Macarewich.

ADOPTION OF AGENDA

It was moved by Trustee Cousar and seconded by Ajigbotafe Cousar to adopt the agenda.

AYES: Little, Geronimo, Ajigbotafe, Lara, Cousar.

NOES: None.

ABSTAIN: None.

ABSENT: None.

PUBLIC COMMENT

None.

CONSENT CALENDAR

It was moved by Secretary Geronimo and seconded by Trustee Cousar to approve all items on the consent calendar.

AYES: Little, Ajigbotafe, Lara, Cousar.

NOES: None.

ABSTAIN: None.

ABSENT: None.

CONSIDERATION OF ITEMS REMOVED FROM THE CONSENT CALENDAR

None.

FINANCE REPORT

Lee noted that the column representing the total percentage spent was added, as Geronimo requested.

DISTRICT DIRECTOR'S REPORT

Lee mentioned that the two electrical outlets in the children's room were repositioned. The library won a \$99,345.80 High-Speed Broadband in California Libraries grant. Fernando went to Burlingame Public Library to pick up four self-checkout machines. The equipment was free and valued at \$9,800.00 each.

**BOARD REPORTS AND COMMENTS
UNFINISHED BUSINESS**

President Little gave thanks to the staff for their hard work.

None.

NEW BUSINESS

10.1 Recognition: Board of Trustees.

Lee presented a Certificate of Appreciation to all the Board members as well as a gift card for their participation as Board members.

10.2 Recognition: Friends of the Banning Library.

Lee presented a Certificate of Appreciation to the Friends of the Banning Library members, as well as a gift card for all the work they have done for the library.

10.3 Announcement of Silent Auction Winners.

Secretary Geronimo and Trustee Cousar announced the winners of the Silent Auction.

10.4 Reserve Two Parking Spaces for Friends of the Banning Library.

It was moved by Trustee Cousar and seconded by Trustee Agijbotafe to approve to reserve two parking spaces (located northwest corner) for the Friends on the Banning Library.

AYES: Little, Ajigbotafe, Lara, Cousar.

NOES: None.

ABSTAIN: None.

ABSENT: None.

RECESS

The Board took a short recess starting at 5:16 p.m.

The Board resumed the meeting at 5:17 p.m.

NEW BUSINESS

10.3 Announcement of Silent Auction Winners.

Secretary Geronimo and Trustee Cousar announced the winners of the Silent Auction.

10.4 Reserve Two Parking Spaces for Friends of the Banning Library.

It was moved by Trustee Cousar and seconded by Trustee Agijbotafe to approve to reserve two parking spaces (located northwest corner) for the Friends on the Banning Library.

AYES: Little, Ajigbotafe, Lara, Cousar.

NOES: None.

ABSTAIN: None.

ABSENT: None.

LAST MINUTE AGENDA ITEMS Trustee Ajigbotafe gave a short going-away speech, since this is her last board meeting as a member.

AGENDA ITEMS FOR FUTURE AGENDAS None.

NEXT REGULAR BOARD MEETING December, 2020 at 5:00 p.m.

ADJOURNMENT Adjourned at 5:27 p.m.

The foregoing minutes are approved by the Board of Trustees on _____, 2020.

Prepared by: Christian Tzintzun, Library Technician

Alex Geronimo, Board Secretary

Banning Library District
Profit & Loss Budget vs. Actual

October 2020

				\$ Over (Under)	
		Jul 20 - Oct 20	Budget	Budget	% of Budget
1	Income				
2	REVENUES				
3	COUNTY REVENUES	\$ 36,579	\$ 980,200	\$ (943,621)	3.73%
4	LOCAL REVENUES				
5	Interest	1,531	10,000	(8,469)	15.31%
6	Late Fees and Misc. Revenue	244	5,000	(4,756)	4.87%
7	Fines	1	3,100	(3,099)	0.04%
8	Service Sales	55	4,100	(4,045)	1.34%
9	Grant Income	11,204	-	11,204	100.00%
10	Rental Fees	-	500	(500)	0.00%
11	Total REVENUES	49,614	1,002,900	(953,286)	4.95%
12	Expense				
13	CAPITAL OUTLAY	-	200,000	(200,000)	0.0%
14	SALARIES & BENEFITS				
15	Regular Salaries	144,262	467,100	(322,838)	30.89%
16	Overtime	-	1,000	(1,000)	0.00%
17	Health Insurance	9,514	26,700	(17,186)	35.64%
18	Social Security	8,516	29,100	(20,584)	29.26%
19	Retirement	5,091	17,800	(12,709)	28.60%
20	Medicare	1,992	6,800	(4,808)	29.29%
21	Unemployment Insurance	369	4,500	(4,131)	8.20%
22	Total SALARIES & BENEFITS	169,744	553,000	(383,256)	30.7%
23	OPERATIONAL				
24	Automation	8,746	20,200	(11,454)	43.30%
25	Maintenance	5,414	16,000	(10,586)	33.84%
26	Program Expense	2,338	14,000	(11,662)	16.70%
27	Juvenile Books (Childrens)	1,520	10,000	(8,480)	15.20%
28	Adult Books	2,128	6,300	(4,172)	33.78%
29	Youth books (YA)	301	1,000	(699)	30.08%
30	Equipment & Furniture	-	10,000	(10,000)	0.00%
31	Data Base	2,005	20,000	(17,995)	10.03%
32	Audio	758	2,700	(1,942)	28.09%
33	DVD/Videos	874	2,700	(1,826)	32.35%
34	Periodical	892	1,500	(608)	59.49%
35	Processing Books & ILL	642	3,800	(3,158)	16.91%
36	Security	608	2,400	(1,792)	25.33%
37	Website Maintenance	-	4,000	(4,000)	0.00%
38	Janitorial	730	2,600	(1,870)	28.09%
39	Total OPERATIONAL	26,957	117,200	(90,243)	23.0%
40	ADMINISTRATIVE				
41	HR Services	22,958	25,000	(2,043)	91.83%
42	Professional	28,954	83,600	(54,646)	34.63%
43	Insurance	6,330	17,000	(10,670)	37.23%
44	Professional Development	2,298	8,000	(5,702)	28.73%
45	Recognition Events	-	1,500	(1,500)	0.00%
46	Recruitment	-	500	(500)	0.00%

Banning Library District
Profit & Loss Budget vs. Actual

October 2020

		\$ Over (Under)		
	Jul 20 - Oct 20	Budget	Budget	% of Budget
47	Advertising/Marketing	-	1,200	(1,200) 0.00%
48	Cty. Auditing and Accounting	-	500	(500) 0.00%
49	Bank Fees	-	200	(200) 0.00%
50	Membership	2,394	4,500	(2,106) 53.20%
51	Travel/Training	244	5,500	(5,256) 4.43%
52	Utilities	12,203	48,000	(35,797) 25.42%
53	Office	7,149	22,700	(15,551) 31.50%
54	Total ADMINISTRATIVE	82,529	218,200	(135,671) 37.82%
55	Total Expense	279,230	1,088,400	(809,170) 25.66%
	Net Income	\$ (229,616)	\$ (85,500)	\$ (144,116)

No assurance is provided on these financial statements.

The financial statements do not include a statement of cash flows.

Substantially all disclosures required by accounting principles generally accepted in the United States are not included.

Banning Library District

Balance Sheet

As of October 31, 2020

	<u>Oct 31, 20</u>
ASSETS	
Current Assets	
Checking/Savings	
Bank of Hemet Money Market	\$ 83,603
Operating Account Bank of Hemet	1,224,094
LAIF	606,341
LAIF FMV	2,962
Petty Cash	1,230
County General Fund Cash	<u>90,702</u>
Total Checking/Savings	2,008,932
Accounts Receivable	
County Interest Receivable	<u>1,663</u>
Total Accounts Receivable	1,663
Other Current Assets	
Prepaid Expenses	<u>25,469</u>
Total Other Current Assets	<u>25,469</u>
Total Current Assets	2,036,064
Fixed Assets	
CAPITAL ASSETS	
County General Fund Assets	1,009,490
Accumulated Depreciation	<u>-572,566</u>
Total Fixed Assets	<u>436,924</u>
TOTAL ASSETS	<u>2,472,988</u>
LIABILITIES & EQUITY	
Liabilities	
Current Liabilities	
Accounts Payable	2,729
Credit Cards	6,484
Payroll Liabilities	363
Year End Accrued Payroll	15,746
Vacation Payable	<u>25,334</u>
Total Liabilities	50,656
Equity	<u>2,422,332</u>
TOTAL LIABILITIES & EQUITY	<u>\$ 2,472,988</u>

**No assurance is provided on these financial statements.*

***The financial statements do not include a statement of cash flows.*

****Substantially all disclosures required by accounting principles generally accepted in the United States are not included.*



21 W. Nicolet St.
Banning, CA 92220
(951) 849-3192 (tel.)
(951) 849-6355 (fax)
www.banninglibrarydistrict.org

DIRECTOR'S REPORT

Meeting Date: December 9, 2020
By: Kevin Lee

- Happy Holidays to everyone! Best wishes for a wonderful holiday and a happy New Year!
- **Website Update.** Website development is going through quality assurance process. This is where they check to make sure everything is properly working. We are also looking for a chat system script to add to the website.
- **Furniture Renovation Update.** Movers were hired to move heavy furniture out of Children's and Teen rooms on December 4, 2020. Non-operating vents in the Children's Room is now removed. Lath & Paster or drywall work will start from Thursday (December 10) after approved by the Board. This should take about three to four days. Paint work will begin on December 16th. It will take two days to complete. The carpet installer will install new carpet tiles on December 21st and 22nd. New furniture will be arriving around January 5th, but the project manager is willing to work with the Library. If the Library needs more time the project manager can push back a week if needed. At this time, it appears to me that we can get everything done on time.
- **Compensation Study.** Koff & Associates completed the Compensation Study. They found that all Banning Library District's base salaries, benefit package, and total compensation are much lower than other comparable public agencies.
- **Friends News.** Big "thank you" to Friends for donating one Christmas Tree. Friends received a donation to start an education fund. It will be named after Eve and Jim Rusk, long time educators in Banning. While it is difficult to meet due to COIVD-19 restrictions, Friends are still having formal meetings and getting things done. Friends members are preparing for a parking lot sale in the future; they will sell books in bundles. Bailiff family donated approximately 600 items to the library. Our Historian is reviewing them. Friends are also continuing the baby book donations to the San Gorgonio hospital. Friends will discuss the annual essay contest soon.
- **\$5,000 e-resource Grant.** We subscribed to Creative-bug, Tumble Math, and Tumble Books with some of the \$5,000 e-resources grant that we won. We are looking into Comic Plus since comic is popular with teens and adults alike in Banning. Creative-bug offers online video arts and crafts workshop and techniques, such as painting, knitting, crocheting, sewing, screen printing, and more. Tumble Math is the most comprehensive collection of math pictures books (it even has animation and narration). There are math quizzes with Tumble math.
- Tumble Books collections include licensed titles form children's book publishers such as Simon & Schuster, Chronicle Books, HarperCollins Publishers, and more.

Creative-bug, Tumble Books, Tumble Math:

The screenshot shows the homepage of the Banning Library District. At the top left is a circular logo with the number '100' and the text 'BANNING DISTRICT'. To the right of the logo is the library's name and address: 'Banning Library District, 21 West Nicolet Street - Banning, CA 92220, 951-849-3192'. Below this is a navigation menu with links for Home, Events, Books and Digital, 4 Kids, Teens, Reference, Local History, Zip Books, and About Us. On the right side of the header are three buttons: 'Browse Our Catalog', 'My Account', and 'Contact Us'. The main content area is divided into three columns. The left column is titled 'Curbside Service Hours' and lists hours for Monday through Sunday. The middle column features a large graphic with the text: 'You now have access to several thousand comics and graphic novels with the click of a mouse!'. The right column is titled 'New to the Banning Library' and features a 'creativebug' logo with the text 'Power by Jo-Ann Stores'. On the far right, there is a vertical stack of logos for 'brainfuse', 'JobNow & VeINow', 'TumbleBooks', 'Tumble Math', and 'TeachingBooks'.

Curbside Service Hours

Monday	10:00 am - 8:00 pm
Tuesday	10:00 am - 5:00 pm
Wednesday	10:00 am - 8:30 pm
Thursday	10:00 am - 8:00 pm
Friday	10:00 am - 8:00 pm
Saturday	10:00 am - 2:00 pm
Sunday	Closed

OPEN NOW APPLY

New to the Banning Library

creativebug
Power by Jo-Ann Stores

brainfuse
JobNow & VeINow
TumbleBooks
Tumble Math
TeachingBooks

- **Roofing Review.** With new furniture coming in, the Library wants to make sure its current roofing is solid. We do not want any furniture damaged by rain, or any leaks. Over about a year, the Library hired a roofing company to repair all areas where there were visible damages. This time, we will seek to fix all areas that needs to be fixed.



21 W. Nicolet St.
Banning, CA 92220
(951) 849-3192 (tel.)
(951) 849-6355 (fax)
www.banninglibrarydistrict.org

STAFF REPORT

Meeting Date: December 9th 2020

Prepared by: *Fernando Morales, Library Manager*

The Banning Library District participated a Lunch at the Library grant program with Carol's Kitchen, in which we handled out 18 Creativity kits over 3 days. Staff has proceeded with doing some of the reorganization of the library as we move items out of the children's room and teen room. They have communicated with each other in order to not lose any items in the Adult Non-fiction area.

TITLE:

Circulation Statistics

Material	Top Circulating Item	Monthly Circulation
Audio Books	Zealot by Reza Aslan	29
DVDs	10 Cloverfield Lane	61
Adult		
Fiction	Stalker by Faye Kellerman	164
Non-Fiction	Eisenhower by Stephen Ambrose	51
Young Adult		
Fiction	Internment by Samira Ahmed	16
Non-Fiction	Just the Facts: Ecstasy By Sean Connolly	1
Juvenile		
Fiction	Animals should definitely not wear clothes	261
Non-Fiction	Thank you, Sarah: The woman who saved Thanksgiving	104



21 W. Nicolet St.
 Banning, CA 92220
 (951) 849-3192 (tel.)
 (951) 849-6355 (fax)
www.banninglibrarydistrict.org

Computer Usage	Total Sessions
Adult	68
Teen	27
Children	0

*Each session is one (30) hour long. One 15-minute extensions are allowed. Staff does give extensions, but the system does not count that as additional sessions.

Database	Description	Total Sessions
Ancestry	Genealogy	0
CreativeBug	Online learning	3
Enki	eBook*	9
Gale Legal Forms	Legal Forms & Templates	7
Mango	Language	12
OverDrive	Audio Book and eBook	373
World Book	Online Encyclopedia	15
BrainFuse	Online Tutoring	15
Hoopla	Movie streaming and eBook	39
Zinio	Magazines	29
JobsNow	Résumé and Job advice	16
VetsNow	Veteran Help	2



21 W. Nicolet St.
Banning, CA 92220
(951) 849-3192 (tel.)
(951) 849-6355 (fax)

www.banninglibrarydistrict.org

STAFF REPORT

Meeting Date: 12/09/2020

Prepared by: *Khiabet Vigil, Library Aide.*

Department: Children

Subject: November Statistics

We completed three weeks of live storytime in November. All storytimes were live streamed on Facebook due to Facebook bringing in more viewers. There are two separate storytime live stream sessions: English & Spanish. The views recorded are a combination of both sessions. I have read two books instead of one, both in English and Spanish. The last week of November, storytime was cancelled due to the Thanksgiving holiday. The live streams were not archived or saved for patrons to view later due to copyright issues. Plans for future live streams in December are to play and sing Christmas songs in the beginning and end of every livestream session. I, too, shall dress up in Christmas theme clothing to spread holiday cheer.

As the shutdown restrictions are still in purple tier, we proceeded with our general children program.

- Live storytime on Instagram and Facebook live

Video Events

Program Week	Platform	views	Explanation
11/05/20	Facebook Live	6	Read 2 books for both English and Spanish sessions. All books were Fall/Thanksgiving Theme.
11/12/20	Facebook Live	6	Read 2 books for both English and Spanish sessions. All books were Fall/Thanksgiving Theme.
11/19/20	Facebook Live	3	Read 2 books for both English and Spanish sessions. All books were Fall/Thanksgiving Theme.



21 W. Nicolet St.
Banning, CA 92220
(951) 849-3192 (tel.)
(951) 849-6355 (fax)
www.banninglibrarydistrict.org

11/26/20	Cancelled Due to Thanksgiving		
----------	--	--	--

Historians Report for November 2020

November was a productive and exciting month for the history room. Several major developments occurred not only logistically but also creatively with new content being created for the first time.

Overall for the month of November 8 people called, and made inquiries on various subjects. Some revolved around our microfilm use and others were general questions about non-Banning related history items. We also began our photo scanning service again, with a project that involves over 500 photos. This will raise approximately 500 dollars for the library.

Logistically speaking, Fernando and the library staff helped me move furniture into the history room to make for more bookshelf space. Bookshelf space was badly needed. Prior to the move, I was using a wire rack that was not easily accessible to patrons to use. The staff and myself moved the largest bookshelf in the young adults room into the history room. Now I will be arranging local history books and our Boud collection on it, to make it fully accessible to the public.

Lastly, Khibet Vigil, myself and the Friends of the Banning Library have begun our new series of original content documentaries, called "Exploring the Pass." This will be an ongoing mini-documentary series of videos that will be posted to the library's Facebook page and Youtube. We have written scripts and began initial filming of our first two episodes. Episode 1 will be about the Fox Theater, and episode 2 about the Banning Airport. We received permission and release forms for interviewing the new operator of the FOX, and associated staff. The initial editing will be finished at sometime in late December.

As we create more original content history programs, we will bring more awareness to the community that we are also a research and historical institution that is taking to new forms of media. The future looks very bright for these projects.

Submitted with respect and gratitude.

-Historian, Francisco Ramos



21 W. Nicolet St.
Banning, CA 92220
(951) 849-3192 (tel.)
(951) 849-6355 (fax)
www.banninglibrarydistrict.org

STAFF REPORT

Meeting Date: December 9, 2020
Prepared By: Kevin Lee, District Director
Agenda Item: 11.1
Title: Oath of Office – Board Trustees

BACKGROUND/INFORMATION:

The Board of Supervisors has appointed Trustees in lieu of election because the scheduled election was not held in the District.

New Trustees will be subscribed and sworn before an authorized official (District Secretary, Registrar of Voters or one of her deputies, or a notary public) before entering upon the. Duties of office and filed promptly with the District Secretary.



21 W. Nicolet St.
Banning, CA 92220
(951) 849-3192 (tel.)
(951) 849-6355 (fax)
www.banninglibrarydistrict.org

STAFF REPORT

Meeting Date: December 9, 2020
Prepared By: Kevin Lee, District Director
Agenda Item: 11.2
Title: Authorize the Director to enter into an Agreement with Vector USA for Network Design and Implementation in the amount of \$99,354.80 – (grant award)

RECOMMENDATION:

Authorize the Director to enter into an Agreement with Vector USA for Network Design and Implementation in the amount of \$99,354.80 – (grant award)

BACKGROUND/INFORMATION:

The Banning Library District uses an outdated network system that needs major updates to meet today's technology and compliance standards. Earlier this year, staff notified the Board at one of its regular meetings that staff planned to apply for a high-speed network grant to update our technology, and to be in a position to be part of Corporation for Education Network Initiatives in California (CENIC)'s California Research and Education Network (CalREN).

The cost of the project is broken down:

1. Technology and Hardware funding:	\$49,892.19
2. Architectural and Building funding:	\$12,885.70
3. Network Consulting funding:	\$8,104.00
4. Upgrades to Inside Wiring funding:	\$23,574.13
5. Technical Network training funding:	\$1,000.00
6. Taxes:	\$3,898.78
Total:	\$99,354.80

We were notified by California State Library that we won the grant award for the full amount. This network design and implementation project will start as soon as the Board authorizes the Director to enter into an agreement with Vector USA. Per grant rule, this project will be completed before June 30th, 2021.

FISCAL IMPACT:

None. The entire project is funded by High-Speed Broadband in California Libraries Grant.



November 6, 2020

Kevin Lee, Director
Banning Library District
21 W Nicolet Street
Banning, CA 92220-4607

Re: High-Speed Broadband in California Libraries Grant – Year 6

Dear Mr. Lee,

This letter constitutes State Library approval of the grant application by the Banning Library District in the following amount(s) for the above-named project:

Technology and Hardware funding: \$49,892.19
Architectural & Building funding: \$12,885.70
Network Consulting funding: \$8,104.00
Upgrades to Inside Wiring funding: \$23,574.13
Technical Network training funding: \$1,000.00
Taxes: \$3,898.78

Total award: \$99,354.80

The grant is effective immediately for the period beginning July 2019 and ending June 2021.

Congratulations on being among the public libraries in California to benefit from this program!

Please work with Christian DeLay, Broadband Project Manager for Califa, who is the administrative and fiscal agent for this project. He may be contacted at cdelay@califa.org. You should expect payment of this grant in whole from Califa.

Periodic narrative and fiscal reports will be required and forms and instructions will follow shortly. The reports should include how funds were expended and a summary of the progress made in fulfilling grant requirements.

Respectfully yours,

Greg Lucas
California State Librarian

Cc: Paula MacKinnon, Executive Director, Califa
Christian DeLay, Broadband Project Manager, Califa

**BANNING LIBRARY DISTRICT
RFB NO. 20-01
NETWORK DESIGN AND IMPLEMENTATION REQUEST FOR QUOTE**

AGREEMENT

THIS AGREEMENT, dated the 8th day of December, 2020, in the County of Riverside, State of California, by and between the Banning Library District, hereinafter referred to as "LIBRARY" or "OWNER" and Vector Resources, Inc. dba VectorUSA, hereinafter referred to as "CONTRACTOR".

WITNESSETH

That the LIBRARY and the CONTRACTOR, for the consideration stated herein, agree as follows:

1. **Contract:**

The complete contract includes all of the contract documents, including the Request for Bid, Supplemental Terms and Conditions, Insurance Policies, General Conditions, Special Conditions if any, Specifications, this Agreement, and all modifications and amendments thereto, and by this reference are incorporated herein. The contract documents are complementary, and what is called for by any one shall be as binding as if called for by all.

2. **Statement of Work:**

CONTRACTOR shall perform that work designated in CONTRACTOR'S response to RFQ. CONTRACTOR shall perform within the time set forth in Paragraph 4 of this Agreement everything required to be performed, and shall provide and furnish all the labor, materials, necessary tools, expendable equipment, and all utility and transportation services as described in the complete contract and required for the work described as follows:

NETWORK DESIGN AND IMPLEMENTATION REQUEST FOR QUOTE

in accordance with specifications provided by the LIBRARY in the Request for Bid documents. All of said work to be performed and materials to be furnished shall be completed in a good workmanlike manner in strict accordance with the Plans, Drawings, Specifications and provisions of the complete contract as hereinabove defined. The CONTRACTOR shall be liable to the LIBRARY for any damages arising as a result of a failure to fully comply with this obligation.

3. **Compensation:**

LIBRARY shall pay to the CONTRACTOR, as full consideration for the faithful performance of the contract, subject to any additions or deductions as provided in the contract documents, the sum of **\$99,354.80** said sum being the total amount of the following amounts stipulated in the bid form.

4. **Time For Completion:**

NETWORK DESIGN AND IMPLEMENTATION PROJECT AT BANNING LIBRARY DISTRICT WILL BE COMPLETED BY June 30th, 2021. A Notice to Proceed shall not require that

work be commenced less than five (5) calendar days from the date of issuance and receipt of said notice. LIBRARY and CONTRACTOR stipulate and agree that the amount of time for completion as specified in this paragraph is reasonable.

5. Indemnification:

(a) The CONTRACTOR agrees to and does hereby indemnify and hold harmless the LIBRARY, its officers, agents, and employees from every claim or demand made, and every liability, loss, damage, or expense, of any nature whatsoever, which may be incurred by reason of:

- (1) Liability for damages for (1) death or bodily injury to person; (2) injury to, loss or theft of property; or (3) any other loss, damage or expense arising under either (1) or (2) above, sustained by the CONTRACTOR or any person, firm or corporation employed by the CONTRACTOR upon or in connection with the work called for in this Agreement, except for liability resulting from the sole negligence or willful misconduct of the LIBRARY, its officers, employees, agents or independent contractors who are directly employed by the LIBRARY, and except for liability resulting from the active negligence of the LIBRARY.
- (2) Any injury to or death of persons or damage to property caused by any act, neglect, default or omission of the CONTRACTOR, or any person, firm, or corporation employed by the CONTRACTOR, either directly or by independent contract, including all damages due to loss or theft, sustained by any person, firm or corporation, including the LIBRARY arising out of, or in any way connected with the work covered by this Agreement, whether said injury or damage occurs either on or off school LIBRARY property, if the liability arose from the negligence or willful misconduct of anyone employed by the CONTRACTOR, either directly or by independent contract, and not by the active negligence of the LIBRARY.

(b) The CONTRACTOR, at CONTRACTOR'S own expense, cost, and risk shall defend any and all actions, suits, or other proceedings that may be brought or instituted against the LIBRARY, its officers, agents or employees, or any such claim, demand or liability, and shall pay or satisfy any judgment that may be rendered against the LIBRARY, its officers, agents or employees in any action, suit or other proceedings as a result thereof.

(c) In accordance with Section 9201 of the Public Contract Code, the LIBRARY shall timely notify the CONTRACTOR of any third-party claim it receives relating to the Contract. The CONTRACTOR shall promptly reimburse LIBRARY for the reasonable costs incurred in providing the CONTRACTOR such notification.

6. Insurance:

CONTRACTOR shall take out, prior to commencing the work, and maintain, during the life of this contract, and shall require all subcontractors, if any, whether primary or secondary, to take out and maintain the following policies issued by insurance companies authorized to transact business in the State of California and which comply with all requirements of the Department of Insurance for the State of California:

- | | | |
|-----|---|---|
| (a) | Public Liability Insurance for injuries including accidental death, to any one person in an amount not less than | \$ <u>1,000,000.00</u>
per occurrence |
| | and, | |
| (b) | Subject to the same limit for each person on account of one accident, in an amount not less than | \$ <u>1,000,000.00</u>
per occurrence
\$ <u>1,000,000.00</u>
aggregate |
| | and, | |
| (c) | Property Damage Insurance in an amount not less than | \$ <u>1,000,000.00</u>
per occurrence
\$ <u>1,000,000.00</u>
aggregate |
| | and, | |
| (d) | Comprehensive Automobile Liability Insurance covering the use of all owned, non-owned and hired vehicles with combined bodily injury and property damage in an amount not less than | \$ <u>1,000,000.00</u>
per occurrence
\$ <u>1,000,000.00</u>
aggregate |

7. Copies of Drawings and Specifications:

If applicable, the LIBRARY will furnish **FOUR (4)** copies of drawings and specifications, free of charge. Additional copies may be obtained at cost of reproduction.

8. Substitution of Securities:

Pursuant to Section 22300 of the Public Contract Code, this Contract permits the substitution of securities for any monies withheld by the LIBRARY to ensure performance under this Contract. At the request and expense of the CONTRACTOR, securities equivalent to the amount withheld shall be deposited with the LIBRARY, or with a state or federally chartered bank in California as the escrow agent, who shall then pay such monies to the CONTRACTOR. Upon satisfactory completion of the Contract, the securities shall be returned to the CONTRACTOR. Alternatively, the CONTRACTOR may request and the LIBRARY shall make payment of retentions earned directly to the escrow agent at the expense of the CONTRACTOR.

Securities eligible for investment under this section shall include those listed in section 16430 of the Government Code, or bank or savings and loan certificates of deposit. The CONTRACTOR shall be the beneficial owner of any securities substituted for monies withheld and shall receive any interest thereon.

9. Corporate Status:

CONTRACTOR is a corporation. The undersigned hereby represents and warrants that the corporation is duly incorporated and in good standing in the State of California, and that Robert Messinger, whose title is Executive Vice President, is authorized to act for and bind the corporation.

10. Required Provisions:

Each and every provision of law and clause required by law to be inserted in this Contract shall be deemed to be inserted herein and the contract shall be read and enforced as though it were included herein, and if through mistake or otherwise any such provision is not inserted, or is not correctly inserted, then upon application of either party the Contract shall forthwith be physically amended to make such insertion or correction.

11. Entire Agreement.

The complete contract as set forth in Paragraph 1 of this Agreement constitutes the entire Agreement of the parties. No other agreements, oral or written, pertaining to the work to be performed under this contract, exists between the parties. This contract can be modified only by an agreement in writing, signed by both parties and pursuant to action of the Governing Board.

IN WITNESS WHEREOF, the parties hereto have caused this Agreement to be executed.

BANNING LIBRARY DISTRICT

**VECTOR RESOURCES, INC. dba
Vector USA**

By:

By: Robert Messinger

Its:

Its: Executive Vice President

Date:

Date: 12/08/2020

(signature)



(signature)

Contractor License Number: 654046

Banning Library District

Network Design and Implementation

August 26, 2020

Prepared by:

Ryan Stachowiak

Strategic Account Manager



August 26, 2020

Banning Library District
21 West Nicolet Street
Banning, CA 92220

Re: Network Design and Implementation RFQ

Dear Banning Library Team,

Vector Resources, Inc. dba VectorUSA is pleased to submit our proposal in response to your **Network Design and Implementation RFQ**. Our proposal is based on careful review of all guidelines and specifications set forth in your RFP and site walks.

VectorUSA is uniquely qualified to handle this project due to our:

Proven Track Record – VectorUSA is one of California’s premiere network integration companies. We design, build, and maintain efficient, manageable and flexible systems. Our company attributes its success to being self-sufficient; we are small enough to adapt to changes quickly yet large enough to handle sizeable projects.

Dependability – VectorUSA has a \$125 million project bonding capacity, an excellent corporate credit rating, and a customer reputation for executing all manner of network projects on time and on budget.

Capacity – With over 320 employees spread among 5 offices (3 in California, 1 in Arizona, and 1 in North Carolina), VectorUSA has the capacity to successfully execute all aspects of the Banning Library District’s project on time and under budget.

Cost-effectiveness – VectorUSA is conscious of the limited funding available to library districts. We understand that every penny used is valuable and therefore design and build our networks in the most cost-effective manner possible.

Versatility – Although VectorUSA’s resume in the education space is without peer, our Company also executes enterprise-level technology projects for Fortune 500 Companies, global shipping and logistics companies, major research hospitals, and all varieties of small and medium-sized businesses.

We look forward to the possibility of assisting Banning Library District with your advanced technology initiatives. We appreciate the opportunity to submit this bid for your consideration and stand ready to respond to any questions or requests for additional information.

Sincerely,

A handwritten signature in black ink that reads "Ryan". The signature is cursive and fluid, with the first letter "R" being particularly large and stylized.

Ryan Stachowiak
Strategic Account Manager
VectorUSA
(310) 436-1071
www.vectorusa.com



CONTRACTOR QUALIFICATIONS

Company Profile

VectorUSA is one of America's premiere technology companies, designing, building and maintaining voice, data and video networks. With over 32 years of experience and more than 330 employees, 40 service vehicles and 90 certified IT professionals across six brick and mortar locations, we have the ability to provide stellar service to our clients. We work closely with our technical partners to provide customized solutions for public and private K12 and higher education schools, ports and terminals, hospitals, large and small commercial enterprises, and state, local, and federal agencies.

Vector Resources, Inc. dba VectorUSA is a California C Corporation and is privately held. Vector is headquartered at 20917 Higgins Court, Torrance, CA 90501 with additional offices in San Diego, Rancho Cucamonga, Phoenix, AZ and Charlotte, NC. Thanks in part to our size, experience, and educated staff, we have highly trained resources that can both mobilize and scale quickly to accommodate Banning Library District's needs.

Our successful record fulfilling large implementation projects combined with our position as a privately owned, financially sound company enables us to bond projects up to \$150 million in aggregate. Never having filed for bankruptcy in our 32-year history, our financial health is very strong (D&B # 19-536-8774). Our successful record fulfilling large implementation projects combined with our position as a privately owned, financially sound company enables us to maintain an "A" corporate rating. VectorUSA is not currently undertaking in any pending lawsuit or litigation or has any occurred within the last five years. Also, VectorUSA has not had any claim or settlement resulting in payment by us or our insurers within the last five years.

One of the byproducts of an established resume within the public sector space is that we have acquired a unique understanding of labor compliance laws and regulations. We have detailed experience with prevailing wage shift differential and certified payroll. In the 32 years Vector has been in business, we have not only successfully passed several audits at the state level with zero findings, we have a Federal Government sales team that also deals with the Davis Bacon Wage Act. Needless to say, we have a top-notch labor compliance department that operates under the sole charter of protecting both you and us in terms of payroll compliance.

VectorUSA brings to The Banning Library District a proven capability to execute mission-critical Information Technology projects on time and on budget. We maintain a C7 (low voltage), C10 (electrical), and a General Contractor "B" license. VectorUSA's certifications and partnerships allow us to serve as a full service solution provider. Our business partners include: APC, Aruba, Axis, Berk-Tek, Cisco, Corning, Commscope, Fortinet, HPE Networking, Leviton, OnSSI, Ortronics, Samsung, Sumitomo (Air-Blown Fiber), TE Connectivity, Tripp Lite, Vicon, and many others.

VectorUSA has a long and successful history of designing, implementing & supporting complex technology infrastructure systems for clients throughout North America. Recognizing our customer's need to increase collaboration, improve service levels and provide a faster more resilient technology environment, VectorUSA provides comprehensive technology solutions including design,



implementation, and support services. VectorUSA has also developed a successful managed services practice over the past six years that allows our customers to take advantage of two fully-staffed Network Operations Centers (NOC) in Torrance, CA and Charlotte, NC. These two NOC's provide our customers with exceptional technical support and service levels that allow VectorUSA to deliver cost effective managed services with a high level of service integrity 24 hours per day, 365 days per year.

We understand the complex demands of today's dynamic technology environment. The breadth of our services and the depth of our expertise give us exceptional abilities to deliver the best network solutions for our customers. As VectorUSA expands our range of services, we continue to deliver smart technology solutions including Unified Communications and Collaboration, Innovative Infrastructure, Intelligent Surveillance, and Managed Solutions, helping businesses operate more securely and efficiently. No other network integration company performs for its customers with the speed, agility and responsiveness of VectorUSA - providing our customers with the power to connect people to information and the world.

aruba
a Hewlett Packard
Enterprise company



**VECTOR RESOURCES,
INC.**

UNITED STATES

**Qualifies as a Platinum Partner in the Aruba
Partner Ready for Networking Program for
HPE Fiscal Year 2020**

Specializations
Switching
Wireless LAN

Competencies
ClearPass Policy Management

A handwritten signature in black ink, appearing to read 'Jim Harold'.

Jim Harold
Vice President
North America Aruba
Channel

STATE OF CALIFORNIA

Contractors State License Board

Pursuant to Chapter 9 of Division 3 of the Business and Professions Code and the Rules and Regulations of the Contractors State License Board, the Registrar of Contractors does hereby issue this license to:



CONTRACTORS STATE LICENSE BOARD
ACTIVE LICENSE

654046

VECTOR RESOURCES INC DBA VECTORUSA

License Number 654046

VECTOR RESOURCES INC

to engage in the business or act in the capacity of a contractor in the following classification(s):

C-7 C10 B C61/D56



**C-7 - LOW VOLTAGE SYSTEMS
C10 - ELECTRICAL**

09/30/2020

www.csib.ca.gov

**B - GENERAL BUILDING CONTRACTOR
D56 - TRENCHING (ONLY)**

Witness my hand and seal this day,

December 7, 2012

Issued September 11, 1992

James Miller
**James Miller
Board Chair**

Stephen P. Sands

**Stephen P. Sands
Registrar of Contractors**

This license is the property of the Registrar of Contractors, is not transferable, and shall be returned to the Registrar upon demand when suspended, revoked, or invalidated for any reason. It becomes void if not renewed.



SCOPE OF WORK

VectorUSA is pleased to present the following proposal to Banning Library District.

Summary:

VectorUSA has proposed to provide, configure, and install a turnkey solution for network systems upgrades as outlined in provided Banning Library District "Network Design and Implementation RFQ". The VectorUSA design entails the consolidation of the existing cabling system into a single point/location (MDF Cabinet) to be in the back-office server room. All new equipment will be installed in the new cabinet.

Overview:

VectorUSA will Meet with key library staff to review the VectorUSA network design, obtain configuration specifications, identify the capacity and interoperability of legacy systems to remain in operation, and to review the project plan and cutover schedule. Vector will install all new equipment to run in conjunction with legacy systems. Once the new equipment has been installed and tested, VectorUSA will work with the client to develop a cutover schedule to move the new equipment in production.

A new MDF will be established to centralize network equipment in a single location in the server room located in the back-office. For the new MDF cabinet VectorUSA has chosen the Chatsworth Products (CPI) GT-Series GlobalFrame Gen 2 Cabinet System with Passive Cooling to address the HVAC requirement in the RFQ.

CPI Passive Cooling® Solutions offer innovative techniques that allow you to manage the flow of air throughout your data/server room without the need for added cooling system units. From small applications with heat loads of 2 kW per cabinet to large data centers with high heat densities up to 32 kW, CPI Passive Cooling Solutions offer smart, proven technology to reduce your cooling cost. As the Simply Efficient™ choice, CPI Passive Cooling Solutions allow you to meet tiered requirements for operation of your IT equipment and to deploy the latest servers, switches and blade servers from HP, IBM, Dell, Huawei, Cisco, Juniper Networks and Brocade with confidence.

VectorUSA will install a new HPE/Aruba wireless network and HPE switching infrastructure. The HPE components specified in the solution come with limited lifetime warranty included. Management will be accomplished through Aruba Central included in the proposal. Aruba Central delivers full-service AI insights, security and unified infrastructure management for campus, branch, remote, and data center networks – all from a single pane of glass.

Implementation:

VectorUSA will establish a project team comprised of individuals with knowledge and experience relevant to this project. An experienced project manager or project coordinator will head the project team to ensure that the project is on schedule and within budget.

In addition to the core project team, VectorUSA has over 400 employees with a full range of specialties who will assist on the project as needed. Among these employee resources are VectorUSA's quality



control officials, who will visit the project site over the course of the project to ensure that the highest-quality installation practices are being used.

VectorUSA recommends that the client create its own project team prior to the project's start. This team will work together with Vector's team to determine the implementation schedule, establish policies and procedures, decide best methods to train and distribute information to client's staff members, resolve technical issues, device management and maintenance, and system maintenance.

All work performed on this project will be installed in accordance with IEEE 802.11 installation guidelines, the current edition of the NEC, NESC, BICSI Telecommunications Distribution Methods Manual (TDMM), BICSI Cabling Installation Manual, and the latest issue of the ANSI/TIA/EIA Standards, along with all state/local codes and ordinances.

GT-Series GlobalFrame® Gen 2 Cabinet System

An easy-to-use, computer and network equipment storage cabinet that complies with data center, computer room and premise network equipment room requirements.

KEY FEATURES

- Cabinet solution adaptable to server, network or mixed-use application
- Standard configuration includes perforated front and rear doors to support front-to-rear airflow
- Vertical Exhaust Duct configuration for high-density applications
- Sized to match industry standards
- Supports up to 1300 kg (2866 lb) of equipment
- Thermal, power and cable management accessories

USE WITH



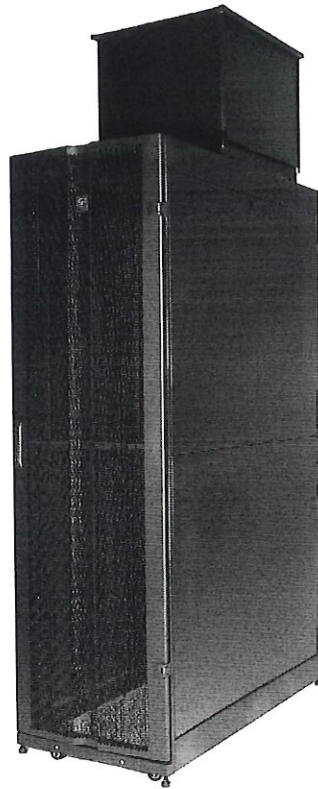

- PDU Mounting Brackets
- Bottom Panel
- Cable Lashing Bracket
- Klik-Nut® Hardware Kit

RELATED PRODUCTS

- Snap-In Filler Panels
- Rack-Mount Shelf
- Rack-Mount PDUs



ADVANTAGES

- 
Vertical Exhaust Duct Configuration
 Captures and removes hot exhaust air from the cabinet to optimize efficiency for high-density applications.
- 
Cable Openings
 Brush-covered cable openings in the top panel provide easy access for overhead cabling.
- 
Perforated Doors
 The standard configuration has perforated front and rear doors to support front-to-back airflow.
- 
Lockable Side Panels
 Two piece side panels for easier handling provide easy access to equipment and cables.

SPECIFICATIONS

Description	Freestanding equipment cabinet provides front and rear support for 482.6 mm (19"W) EIA rack-mount equipment and shelves
Environment	For indoor use only, in environmentally controlled areas; not harsh environments or in air-handling spaces
Includes	Welded and bolted steel four-post frame
	Equipment mounting rails, two pairs
	Factory installed grounding/bonding system
	Leveling feet and casters; Baying kit
	Solid top panel with two or four brush-covered cable access ports
Load Capacity	Perforated metal front door; Double perforated or solid metal rear door
	Solid metal side panels (optional)
Equipment Space	1300 kg (2866 lb), stationary on leveling feet
Material/Construction	See Height, Width and Depth tables under ordering information
Grounding/Bonding:	Steel; Welded/bolted frame, mounting rails screw to frame
Finish	Mounting rails, top panel, side panels and doors are electrically bonded to the cabinet frame. A mounting location for a ground lug is provided on the cabinet frame.
	Epoxy-polyester hybrid powder coat in Black and Glacier White

Availability: Asia Pacific

United States

Agoura Hills, CA
800-834-4969

Canada

Toronto, Ontario, Canada
+905-850-7770

chatsworth.com • techsupport@chatsworth.com

Europe

+44-1628-524-834
chatsworth.com

Middle East & Africa

Dubai, UAE
+971-4-2602125
Doha, Qatar
+974-4-267427

Latin America

+52-55-5703-7525
Toll Free within Mexico
800-01-7592
chatsworth.com.mx

Asia Pacific

+66 21 6880-0266
chatsworth.com.cn



CHATSWORTH
PRODUCTS

SPECIFICATIONS

Doors/Latches	Front door is curved, perforated metal
	Rear door is flat, perforated or solid metal
Side Panels	Swing handle latch with keyed lock
	Easy to remove; reversible to open from the right or left
Top Panel	Order with cabinet or as an accessory
	Solid, two-piece interlocking panels (half-height, full-depth) with a single recessed lock located near the top, center of the panel, keyed to match the front/rear door
Equipment Support	Solid top panel with four rectangular 100 mm x 225 mm (3.9" W x 8.9" D) brush-covered cable openings (one per corner) on the standard configuration
	Tool-less installation and removal (after removing shipping fasteners), spring-release pins secure the panel on the cabinet frame
Equipment Support	Two pairs of equipment mounting rails in the cabinet
	Adjustable depth; fixed 25 mm (1.0") increments, rails screw into frame
	Marks on frame for easy vertical alignment
	44.45 mm (1.75" H) U spacing, marked and numbered bottom-to-top on all rails
	Universal, 19" W, 15.9 mm – 15.9 mm – 12.7 mm (5/8" - 5/8" - 1/2") vertical hole spacing complies with EIA/ECA-310-E
	Square-punched mounting holes accept Klik-Nut Hardware Kits and standard cage nuts
	Includes attachment points for accessory snap on Cable Ring Kits, order separately

The GT-Series GlobalFrame® Gen 2 Cabinet System is an easy-to-use, computer and network equipment storage cabinet that complies with data center, computer room and premise network equipment room requirements.

The GT-Series GlobalFrame Gen 2 Cabinet will support up to 1300 kg (2866 lb) of equipment load. Equipment mounting rails are adjustable in depth in fixed 25 mm (1 in) increments and the markings on the frame provide easy vertical alignment during adjustment. The rails feature a Z-shaped design and have attachment points along the sides for accessory cable rings that create a vertical pathway for cables. Every cabinet includes a top panel, front and rear doors, transport casters and leveling feet.

The GT-Series GlobalFrame Gen 2 Cabinet is configured standard with perforated metal front and rear doors to support front-to-rear airflow in traditional hot aisle/cold aisle applications. The standard configuration features a solid top panel with four brush-covered openings for cable access (one per corner) and a double (vertically split) rear door for easy access to equipment. The side panel is a two-piece panel (top half/bottom half) for easier handling. A high-density Vertical Exhaust Duct configuration is also available for 42U and 45U height cabinets.

Create a cabinet solution that fits your needs by selecting specific thermal, cable and power management accessories. See inside for product details. Contact CPI Technical Support or visit the CPI website (www.chatsworth.com.cn or www.chatsworth.com.cn/gt-series for additional product information.)

DIMENSION TABLES

Height Dimensions – mm (in)			
Rail Height	42U	45U	48U
Overall Height, Casters included	2013 (79.3)	2147 (84.5)	2281 (89.7)
Frame Opening, Front	1876 (73.9)	2010 (79.1)	2144 (84.3)

Width Dimensions – mm (in)		
Nominal Width	600	800
Overall Width	600 (23.6)	800 (31.5)
Frame Opening, Front	508 (20.0)	708 (27.9)
Panel Width	482.6 (19" EIA)	482.6 (19" EIA)

Depth Dimensions – mm (in)				
Nominal Depth	800	1000	1100	1200
Overall Depth with Doors	829 (32.6)	1029 (40.5)	1124 (44.3)	1229 (48.4)
Frame Depth, At Base, No Doors	800 (31.5)	1000 (39.4)	1100 (43.3)	1200 (47.2)
Min./Max. Rail Depth, 600 mm Cabinet ¹	N/A	183 (7.2)/ 879 (34.6)	183 (7.2)/ 979 (38.5)	183 (7.2)/ 1079 (42.5)
Min./Max. Rail Depth, 800 mm Cabinet ¹	173 (6.8)/ 668 (26.3)	173 (6.8)/ 868 (34.2)	173 (6.8)/ 968 (38.1)	173 (6.8)/ 1068 (42.0)

Dimension Notes:
 1. When adjusted to maximum depth, mounting rails wrap around the frame uprights (corner posts). Cable Ring Kits cannot be attached to the rails when they are set to maximum depth.

DIMENSIONAL DRAWINGS:

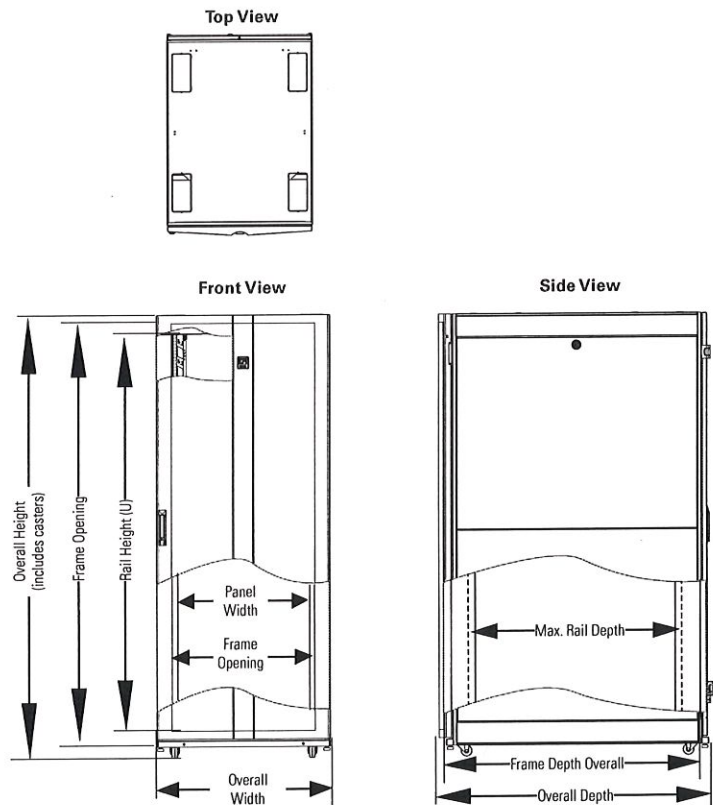

ORDERING INFORMATION

Use the part number matrix below to select a GT-Series GlobalFrame Gen 2 Cabinet. Choose the Width, Depth and Side Panels to form a part number.

Example Part Number: **GT-1C420-CA**.

- Standard Top Panel Configuration has perforated front/rear doors. Vertical Exhaust Duct configuration has perforated front/solid rear doors.
- Four frame sizes to choose from—two heights, four widths, two depths.
- Includes a cabinet frame, two pairs of 482.6 mm (19"W) EIA square-punched equipment mounting rails, a solid or Vertical Exhaust Duct top panel, a perforated front door, a double perforated or solid rear door, swing handle latches, keyed locks, casters, leveling feet and baying kit.
- Supports 1300 kg (2866 lb) static load on leveling feet. Casters are designed for moving an empty cabinet into position before loading equipment. The leveling feet should be extended prior to adding equipment to the cabinet.

GT	-	H	W	D	S	C	-	C	F
----	---	---	---	---	---	---	---	---	---

	1. Height			2. Width			3. Depth			4. Side Panels		5. Configuration	6. Color		7. Frame			
	U	mm	in	mm	in	mm	in	mm	in	Description	Description	Description	Description	Description				
GT-	1	42	2013	79.3	A	600	23.6	2	1000	39.4	0	No Sides	0	Standard Top Panel/Standard Pallet	C	Black	A	4-Slide
	2	45	2147	84.5				5	1100	43.3	1	One Side			E	Glacier White		
	3	48	2281	89.7				4	1200	47.2	2	Two Sides						

	1. Height			2. Width			3. Depth			4. Side Panels		5. Configuration	6. Color		7. Frame			
	U	mm	in	mm	in	mm	in	mm	in	Description	Description	Description	Description	Description				
GT-	1	42	2013	79.3	C	800	31.5	1	800	31.5	0	No Sides	0	Standard Top Panel/Standard Pallet	C	Black	A	4-Slide
	2	45	2147	84.5				2	1000	39.4	1	One Side			E	Glacier White		
	3	48	2281	89.7				5	1100	43.3	2	Two Sides						

	1. Height			2. Width			3. Depth			4. Side Panels		5. Configuration	6. Color		7. Frame			
	U	mm	in	mm	in	mm	in	mm	in	Description	Description	Description	Description	Description				
GT-	1	42	2013	79.3	A	600	23.6	4	1200	47.2	0	No Sides	1	Vertical Exhaust Duct, 20-34 in (500-850 mm)	C	Black	A	4-Slide
	2	45	2147	84.5	C	800	31.5				1	One Side						
												2			Two Sides			

Ordering Notes:

1. Height: Three heights are available: 42U, 45U and 48U. Height is listed as rack-mount units (U). Vertical Exhaust Duct option is only available for 42U and 45U heights. See DIMENSIONS for overall height dimension.
2. Width: Two widths are available: 600 mm (23.6 in) and 800 mm (31.5 in). The cabinet includes equipment mounting rails spaced for 482.6 mm (19" EIA) rack-mount equipment.
3. Depth: Four depths are available: 800 mm (31.5 in), 1000 mm (39.4 in), 1100 mm (43.3 in) and 1200 mm (47.2 in). Doors add approximately 25 mm (1 in) to overall depth. See DIMENSIONS for details.
4. Side Panels: Three configurations are available: no sides, one side or both sides.
5. Finish: Black and Glacier White. Vertical Exhaust Duct version is only available in black.



GT-1C420-CA

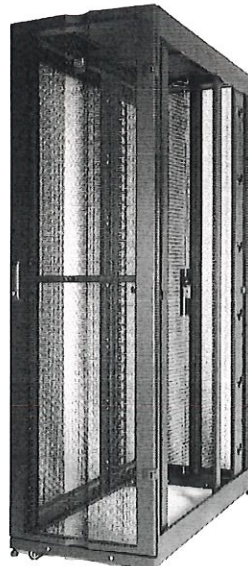

GT-1C400-CA

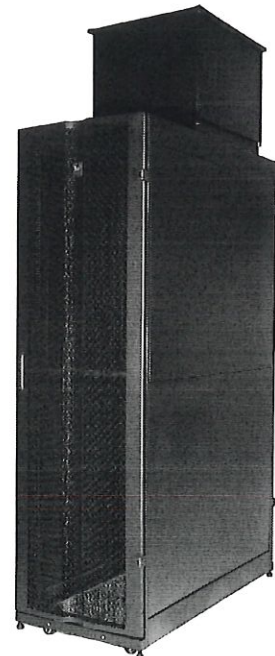

GT-1A421-CA

THERMAL MANAGEMENT ACCESSORIES

Enhance thermal performance by controlling airflow through the cabinet using the following accessories.



Bottom Panel

The Bottom Panel prevents airflow from entering the bottom of the cabinet.

- Solid panel with one brush-covered opening at the rear.
- Match to the width and depth of the cabinet.



Side Panel

One locking side panel with key, allowing easy installation.



Air Dam Kit

Use in the 800 mm (31.5"W) cabinet to seal the space between the equipment mounting rails and the side panels within the cabinet. With 8 cable pass ports, includes a set of equipment rail grommet kit (P/N 39133-001). Use with Snap-In Filler Panels.



Snap-In Filler Panels

Use Snap-In Filler Panels to seal any open rack-mount spaces in the cabinet. Snap-In Filler Panels combine with Air Dam Kit to create a one-way airflow pathway within the cabinet that separates hot and cold air. Snap-In Filler Panels are available in 1U and 2U versions.



Equipment Rail Grommet Kit

Set of plastic grommets that cover cable openings in the equipment mounting rails in the 800 mm wide cabinets to block airflow around equipment.

- Grommets are plastic, snap on, seal cable openings and can be cut to pass cables
- Includes: (8) grommets
- Material: Plastic



Fixed Shelf

Fixed shelf with 445 mm (17.5") W x 653 mm (25.7") D surface, supports up to 100 kg (220 lb) of equipment. Mounting hardware included.

Part Number	Description	Shipping Weight kg (lb)
Bottom Panel		
26130-X08	For 800 mm x 800 mm (31.5"D x 31.5"W) Cabinets	9.9 (22)
26130-X11	For 800 mm x 1000 mm (31.5"W x 39.4"D) to 800 mm x 1200 mm (31.5"W x 47.2"D) Cabinets	15.0 (33)
26130-X03	For 600 mm x 1000 mm (23.6"W x 39.4"D) to 600 mm x 1200 mm (23.6"W x 47.2"D) Cabinets	13.2 (29)
Side Panel		
26330-X00	For 42U x 800 mm (31.5"D) Cabinets	13.5 (30)
26330-X01	For 42U x 1000 mm (39.4"D) Cabinets	16.1 (35)
26330-X02	For 42U x 1100 mm (43.3"D) Cabinets	17.4 (38)
26330-X03	For 42U x 1200 mm (47.2"D) Cabinets	18.6 (41)
26330-X04	For 45U x 800 mm (31.5"D) Cabinets	14.9 (33)
26330-X05	For 45U x 1000 mm (39.4"D) Cabinets	17.4 (38)
26330-X06	For 45U x 1100 mm (43.3"D) Cabinets	18.7 (41)
26330-X07	For 45U x 1200 mm (47.2"D) Cabinets	20.0 (44)
26330-X08	For 48U x 800 mm (31.5"D) Cabinets	16.3 (36)
26330-X09	For 48U x 1000 mm (39.4"D) Cabinets	18.9 (41.7)
26330-X10	For 48U x 1100 mm (43.3"D) Cabinets	20.2 (44.6)
26330-X11	For 48U x 1200 mm (47.2"D) Cabinets	21.5 (47.4)
Air Dam Kit		
26250-X00	For 42U x 800 mm (31.5"W) Cabinets	7.7 (17)
26250-X01	For 45U x 800 mm (31.5"W) Cabinets	7.9 (17)
26250-X02	For 48U x 800 mm (31.5"W) Cabinets	7.9 (17)
Snap-In Filler Panels		
34537-001	1U x 19"EIA, Pack of 6, Black	1.8 (4)
34538-001	2U x 19"EIA, Pack of 6, Black	1.8 (4)
Equipment Rail Grommet Kit		
39133-001	Equipment Rail Kit, Pack of 8	0.9 (2)
Fixed Shelf		
26573-X19	1U x 19"EIA	8.1 (18)

X=Color, C=Black, E=Glacier White

ADDITIONAL ACCESSORIES



Vertical Power Strips

Power Strips attach to the PDU Mounting Brackets and distribute power to multiple devices from a single power connection. Choice of plug and outlet styles to match site requirements. Available with a thermal circuit breaker to protect circuits from overload. Optional surge-protection to protect equipment from power spikes. Optional local meters to provide easy voltage and current monitoring. Horizontal Rack-Mount versions also available.

Part Number		Description		Shipping Weight kg (lb)
Non-Surge	Surge-Protected	Plug	Outlets	
15642-212	15642-112	IEC 16A 2P+E	(10)C13/(4)C19	3.6 (8)
15644-212	15644-112	IEC 16A 2P+E	(20)C13/(4)C19	5.0 (11)
15642-222	15642-122	IEC 32A 2P+E	(10)C13/(4)C19	3.6 (8)
15644-222	15644-122	IEC 32A 2P+E	(20)C13/(4)C19	5.0 (11)
Metered				
15643-212	15643-112	IEC 16A 2P+E	(10)C13/(4)C19	3.6 (8)
15645-212	15645-112	IEC 16A 2P+E	(20)C13/(4)C19	5.0 (11)
15643-222	15643-122	IEC 32A 2P+E	(10)C13/(4)C19	3.6 (8)
15645-222	15645-122	IEC 32A 2P+E	(20)C13/(4)C19	5.0 (11)

Other options available. Contact CPI.

CABLE MANAGEMENT ACCESSORIES

Keep network, KVM and power cables separate and organized using the following cable management accessories.

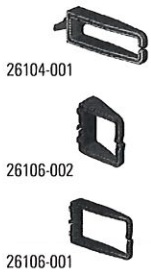

Cable Ring Kit

The Cable Ring Kit includes eight plastic D-rings that snap onto the equipment mounting rails inside the cabinet, creating a vertical pathway for cables. Select the kit to match cabinet width. There are two ring sizes (depths) for 800 mm (31.5") wide cabinets. Each rail can support seven rings. Mounting rails in the 600 mm (23.6") wide cabinet must be setback a minimum of 137.5 mm (5.4") to provide clearance for the cable rings. Mounting rails in the 800 mm (31.5") wide cabinet must be setback a minimum of 125 mm (4.9") to provide clearance for the medium cable ring and a minimum of 250 mm (9.8") to provide clearance for the large cable rings. Cable Ring Kit cannot be used with Vertical Cable Managers (P/Ns 26120-XXX Or 26110-XXX).

Part Number	Description	Shipping Weight kg (lb)
26104-001	Rings For 600 mm Cabinets, Black 43 x 127 (1.7 x 5.0), Outside, 25 x 112 (1.0 x 4.4), Inside	9.9 (22)
26106-002	Medium Rings For 800 mm Cabinets, Black 114 x 119 (4.5 x 4.7), Outside - 81 x 89 (3.2 x 3.5), Inside	15.0 (33)
26106-001	Large Rings For 800 mm Cabinets, Black 114 x 249 (4.5 x 9.8), Outside - 81 x 218 (3.2 x 8.6), Inside	13.2 (29)

Color is Black.

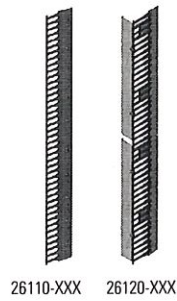

Finger Cable Manager

The Finger Cable Manager attaches to the cabinet's equipment mounting rails, and provides vertical cable management with plastic T-shaped cable guides and openings that align with each rack-mount space (U) in the cabinet to organize patch cords. The manager for the 600 mm (23.6") wide cabinet includes standard fingers only and can be used in either width cabinet. The manager for the 800 mm (31.5") wide cabinet is available with extended fingers and also includes a cover that partially encloses cables. Standard fingers require a 175 mm (6.9") rail setback, and the Extended fingers require a 237.5 mm (9.35") rail setback. The managers cannot be used with Cable Ring Kit (P/Ns 25104-001, 26106-001 or 26106-002). Select to match cabinet width.

Part Number		Description	Shipping Weight kg (lb)
600 mm	800 mm		
26110-X00	26120-X00	For 42U Cabinets	6.8 (15)
26110-X01	26120-X01	For 45U Cabinets	8.6 (19)
26110-X02	26120-X02	For 48U Cabinets	10.4 (23)

X=Color; C=Black, E=Glacier White. For Glacier White finish, the plastic fingers are black finish, the metal finish is white. Shipping weights are for the 800 mm part numbers.



PDU Mounting Brackets

The PDU Mounting Brackets attach to the cabinet frame and provides one or two attachment points for CPI vertical PDUs or power strips for cabinets, and multiple tie points for power cables. Secure cables to the bracket using Saf-T-Grip Straps or cable ties. Tool-less PDU attachment points are located 1645 mm and 1556 mm (64.75" and 61.25") apart. The Single PDU Mounting Bracket is 89 mm (3.5") wide. The double bracket supports two 56 mm (2.2") wide or narrower PDUs side-by-side. The Double PDU Mounting Bracket is 117 mm (4.6") wide and requires a minimum 200 mm (7.8") rail setback in 600 mm wide cabinets and a minimum 187.5 mm (7.4") rail setback in other cabinets.

Part Number	Description	Shipping Weight kg (lb)
26140-X00	Single PDU Mounting Bracket, 42U	6.4 (14)
26141-X00	Double PDU Mounting Bracket, 42U	6.9 (15)
26140-X01	Single PDU Mounting Bracket, 45U	6.5 (14.4)
26141-X01	Double PDU Mounting Bracket, 45U	7.1 (15.7)
26140-X02	Single PDU Mounting Bracket, 48U	6.6 (14.8)
26141-X02	Double PDU Mounting Bracket, 48U	7.3 (15.4)

X=Color; C=Black, E=Glacier White.



Cable Lashing Bracket

The Cable Lashing Bracket Kit attaches to the cabinet frame and provides multiple tie points for cables. Secure cables to the bracket using Saf-T-Grip Straps or cable ties. The kit includes one full height bracket with U-shaped cable tie points and installation hardware. The Cable Lashing Bracket is 124 mm (4.9") wide with two vertical columns of tie points for cables and has a 6500 mm² (10.0 in²) cable fill area. The bracket requires a 175 mm (6.9") rail setback in 600 mm (23.6") wide cabinets and a 125 mm (4.9") rail setback in 800 mm (31.5") wide cabinets.

Part Number	Description	Shipping Weight kg (lb)
26403-X00	For 42U Cabinets	12.6 (28)
26403-X01	For 45U Cabinets	13.5 (30)
26403-X02	For 48U Cabinets	14.4 (32)

X=Color; C=Black, E=Glacier White.

PATENTED



Clik-Nut® Hardware Kit

Redefining the Cage Nut. The design eliminates the need for tools, resulting in easier and faster installation, while maintaining load-bearing strength.

- Easy, tool-less attachment and removal
- Fits .375" (9.5 mm) square hole
- Grip range 16 ga to 12 ga, .060" to .105" (1.52 mm to 2.67 mm panel thickness)
- Includes mounting screws

Part Number	Description	Shipping Weight kg (lb)
76543-001	Clik-Nut Hardware Kit, Cage Nuts, Screws, M6, 25 Pack, Zinc	1 (0.5)
76544-001	Clik-Nut Hardware Kit, Cage Nuts, Screws, #12-24, 25 Pack, Zinc	1 (0.5)
76545-001	Clik-Nut Hardware Kit, Cage Nuts, Screws, #10-32, 25 Pack, Zinc	1 (0.5)

Note: Additional quantities available.

CPI Passive Cooling®, The Simply Efficient™ Choice

CPI Passive Cooling® Solutions offer innovative techniques that allow you to manage the flow of air throughout your data center without the need for added cooling system units, in-row air conditioners or risky liquid cooling solutions. From small applications with heat loads of 2 kW per cabinet to large data centers with high heat densities up to 32 kW, CPI Passive Cooling Solutions offer smart, proven technology to reduce your data center cooling cost. As the Simply Efficient™ choice, CPI Passive Cooling Solutions allow you to meet tiered requirements for operation of your IT equipment and to deploy the latest servers, switches and blade servers from HP, IBM, Dell, Huawei, Cisco, Juniper Networks and Brocade with confidence.

How Passive Cooling Solutions work:

- **Controls Airflow** – CPI Passive Cooling Solutions control airflow through the cabinet using a specific combination of thermal management accessories. Solutions are available for traditional hot aisle/cold aisle environments and containment.
- **Eliminates Re-circulation** – CPI Passive Cooling Solutions create a one-way airflow pathway through the cabinet that eliminates the mixing of hot and cold air. The high-density solution, which includes a Vertical Exhaust Duct to isolate hot air from the room, guarantees heat transfer directly from equipment to the cooling unit.
- **Increases Cabinet Density** – With a Vertical Exhaust Duct, there is no hot aisle, so cabinet heat loads are not limited by the amount of air that can be delivered through the access floor tiles positioned directly in front of the cabinet.
- **Uses Existing Standard Cooling Equipment** – If the cooling capacity of your existing chilled water computer room air conditioners (CRACs) or air handlers (CRAHs) exceeds your heat load, there is no need to add expensive supplemental in-row cooling.

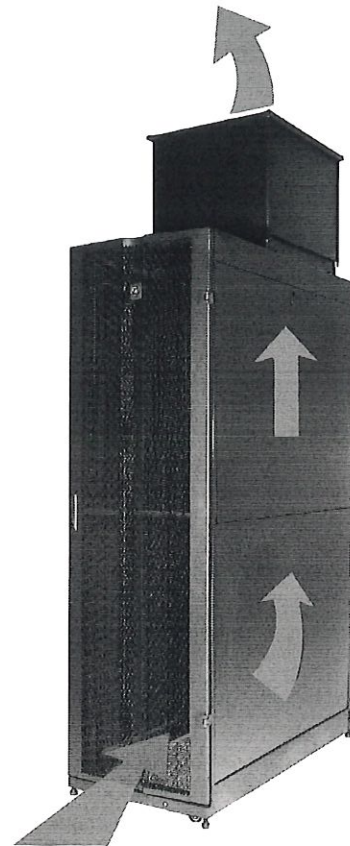

Low Heat Density

Combine:

- GT-Series GlobalFrame Gen 2 with:
 - Perforated Front Door
 - Perforated Rear Door
 - Solid Side Panels
 - Solid Top Panel
- Bottom Panel
- Air Dam Kit
- Equipment Rail Grommet Kit
- Snap-In Filler Panels

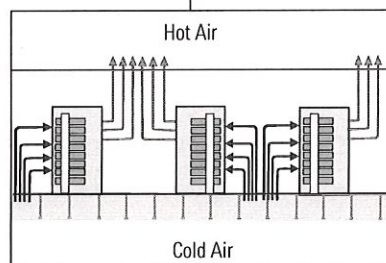

High Heat Density

Combine:

- GT-Series GlobalFrame Gen 2 with:
 - Perforated Front Door
 - Solid Rear Door
 - Solid Side Panels
 - Solid Top Panel and Vertical Exhaust Duct
 - Bottom Panel
- Air Dam Kit
- Equipment Rail Grommet Kit
- Snap-In Filler Panels

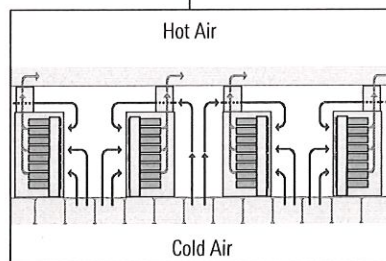

Advantages of using CPI Passive Cooling Solutions – High Heat Density Solution with Vertical Exhaust Duct

- **Eliminates hot spots** – isolating and removing hot exhaust air creates a uniform temperature in the room.
- **No additional power or redundancy requirements** – include no active components.
- **Improves cooling system utilization** – capturing hot exhaust air means higher temperature return air, which improves utilization of chilled water CRACs and CRAHs.
- **Increases chiller efficiency or “free cooling” hours** – isolating hot air allows you to confidently raise the supply air temperature, which allows you to raise the chilled water temperature, and increase potential free cooling hours in most locations.
- **Lowers your operating costs** – the combined effect of better cooling system utilization and more free cooling hours provides lower operating costs.



CHATSWORTH PRODUCTS

REFERENCES

- 1. Project Owner:** Anaheim Elementary School District
Contact Person: Jim Giordano
Phone Number: (714) 517-7532 x4173
Email Address: jgiordano@acsd.k12.ca.us
Address: 1001 S East St, Anaheim, CA 92805

Name of Project: E-Rate Year 19 Technology Upgrade

Initial contract value: \$2,488,953.11

Final contract value: \$2,402,675.41

Liquidated damages: None

Original completion date: June 30, 2017

Date completed: October 26, 2017

Period of Performance: July 1, 2016 – June 30, 2017

Project Overview

VectorUSA provided, configured and installed a district wide (25 sites) Network Equipment upgrade. SFP+ transceivers, SFP+ and PoE+ modules, Switch Chassis' and power supplies were installed within the MDF to support 10Gbe to each IDF. We also provided, configured and installed PoE+ switches, SFP+ modules and transceivers within the IDF's on campus to support 10Gbe. Additionally, VectorUSA installed over 850 AP's and installed, terminated and tested fiber cable to support the 10Gbe from the MDF to each IDF for 18 of the 25 sites.

- 2. Project Owner:** City of West Covina
Contact Person: Shawn Granger
Phone Number: (626) 939-8500
Email Address: shawn.granger@westcovina.org
Address: 1444 W. Garvey Ave., West Covina, CA 91793

Name of Project: Data Network Upgrade

Contract value: \$ 199,113.39

Period of Performance: October 27, 2017 – August 23, 2018

Project Description:

VectorUSA provided, configured, installed, and tested data switches and UPS's based on approved network design review. Installation included the rack mounting of all new data switches and UPS systems in the designated City site locations. Existing data network racks were also utilized for installation. Patch cord connections were moved to designated ports on the new switches.

VectorUSA assembled, transported, mounted, and connected UPS systems directly to each site per the schedule. VectorUSA also installed and configured the SNMP UPS card.

At the completion of the project VectorUSA provided the City with updated switch and UPS documents which included serial numbers/model/location of all switches replaced, serial number/model/location/IP addressing of new switches, and UPS documentation to include IP addressing of the SNMP cards, run-time test results, and warranty information.

3. Project Owner: San Diego Unified School District
Contact Person: Moo Park
Phone Number: 1-619-634-8059
Email Address: mpark@sandi.net
Address: 4860 Ruffner Street, San Diego CA 92111

Name of Project: E-Rate Year 15
Initial contract value: \$45,015,022.06
Final contract value: \$60,974,626.10
Liquidated damages: None
Original completion date: September 30, 2017
Date completed: May 26, 2020
Period of Performance: August 26, 2013 – May 26, 2020.

Project Overview

Vector designed, installed and configured LANs at 69 schools throughout the District. This includes design and installation of communications pathways, cabinets, and copper and fiber cabling infrastructure in compliance with current District specifications. Vector designed, installed and configured complete WLAN systems at the 69 campuses in compliance with current District specifications. Vector also provided, installed and configured all routers and switches located in each campus' MDF, IDF, BDF, and CDF. Vector implemented IP addressing schemes for VLANs at each campus. Additionally the current VoIP system will be expanded at over 15 of the sites; Vector developed a standard implementation for remote site survivability and PSTN access configuration at each site. Vector provided the SDUSD Information Technology Department hard and soft copies of comprehensive as-built CAD (and DSA approved) drawings. Vector submitted fiber optic cable, CAT6 copper cable and wireless LAN performance test results and network diagrams in hard-copy and on CD.



BILL OF MATERIALS

Banning Library District							
Network Design and Implementation							
Material Description	Manufacturer	Part Number	Units	Unit Price	Material	Total	
NETWORK DEVICES, SYSTEMS, COMPONENTS							
<u>Switches</u>							
2930M 40G 8SR PoE Class 6 1s Switch	HPE	ROM67A	1	\$4,250.08	\$4,250.08	\$4,343.08	
2930M 24 Smart Rate PoE+ 1-slot switch	HPE	JL324A	1	\$4,077.67	\$4,077.67	\$4,170.67	
2930 2-port Stacking Module	HPE	JL325A	2	\$401.02	\$802.04	\$864.54	
X372 54VDC 680W 100-240VAC PS	HPE	JL086A#ABA	4	\$280.72	\$1,122.88	\$1,247.88	
HP 2920 0.5 Stacking Cable	HPE	J9734A	2	\$59.97	\$119.94	\$140.77	
<u>Professional Services</u>							
Configuration Services - Network	VectorUSA		1	\$0.00	\$0.00	\$1,000.00	
				Sub-Total	\$10,372.61	\$11,766.94	
WLAN CONTROLLERS, ACCESS POINTS, ANTENNAS							
<u>Access Points</u>							
AP-535 (US) dual-radio 4 x 4:4 802.11ax internal antennas	HPE	JZ337ACM	7	\$588.40	\$4,118.80	\$5,420.80	
AP-577 (US) 802.11ax 2x2:2/4x4:4 Dual Radio Integrated	HPE	R4H23A	1	\$824.53	\$824.53	\$1,103.53	
AP-MNT-MP10-B AP mount kits	HPE	Q9G69ACM	1	\$76.83	\$76.83	\$76.83	
AP-270-MNT-H1 AP-270 Series Outdoor AP Hanging	HPE	JW054A	1	\$50.60	\$50.60	\$50.60	
				Sub-Total	\$5,070.76	\$6,651.76	
NETWORK SERVERS & CORE NETWORK SERVICES							
<u>Firewall</u>							
FortiGate 100 F HW plus 3 yr 24x7 UTM BdI	Fortinet	FG-100F-BDL-950-36	1	\$6,711.25	\$6,711.25	\$7,211.25	
Fortinet 1000Base-LX Transceiver Module	Fortinet	FG-TRAN-LX	1	\$74.75	\$74.75	\$85.17	
Windows Server 2019			2	\$2,319.95	\$4,639.90	\$8,639.90	
HPE 5YR Foundation Care Next Business Day DL160 Gen10			2	\$1,612.49	\$3,224.98	\$3,224.98	
<u>Professional Services</u>							
Configuration Services - Firewall	VectorUSA		1	\$0.00	\$0.00	\$1,500.00	
				Sub-Total	\$14,650.88	\$20,661.30	
NETWORK MANAGEMENT SOFTWARE							
<u>Licenses</u>							
HPE Aruba Central Device Management - subscription license (5 year)	HPE	JZ017AAE	10		\$1,202.40	\$1,827.40	
Professional Services Configuration Services - Aruba Central	VectorUSA		1		\$0.00	\$3,000.00	
				Sub-Total	\$1,202.40	\$4,827.40	
PATCH CABLING & CONNECTORS							
<u>Patch Cabling</u>							
CAT6A slimline patch cord, Blue, 3ft	Generic	C6A-BL-03-S	86	\$4.69	\$403.34	\$669.94	
CAT6A slimline patch cord, Orange, 3ft	Generic	C6A-OR-03-S	32	\$4.69	\$150.08	\$249.28	
CAT6A slimline patch cord, Black, 3ft	Generic	C6A-BK-03-S	10	\$4.69	\$46.90	\$77.90	
CAT6A slimline patch cord, Blue, 10ft	Generic	C6A-BL-10-S	10	\$6.38	\$63.80	\$94.80	
				Sub-Total	\$664.12	\$1,091.92	
HVAC, ENVIRONMENTAL MONITORING							
<u>Environmental Monitoring</u>							
Environmental Sensor	Tripp-Lite	ENVIROSENSE	1	\$143.18	\$143.18	\$174.18	
SmartRack Magnetic Door Switch Kit for front and rear doors;	Tripp-Lite	SRSWITCH	1	\$43.34	\$43.34	\$89.84	
Environmental Sensor w/ Temp & Humidity Monitor &	Tripp-Lite	E2MTHDI	1	\$130.15	\$130.15	\$161.15	
				Sub-Total	\$316.67	\$425.17	
INDOOR ELECTRICAL UPGRADE							
<u>New Outlet</u>							
Electrical Outlet for new cabinet	VectorUSA		2	\$826.04	\$1,652.08	\$8,260.08	
				Sub-Total	\$1,652.08	\$8,260.08	



RACKS, CABINETS, CABLE MANAGEMENT, PDU'S							
Cabinet							
GT-Series GlobalFrame® Gen 2 Cabinet w/ Vertical Exhaust Duct	CPI	TS1520100	1	\$4,081.25	\$4,081.25	\$5,569.25	
PDU							
PDU Metered 120V 20A 28 Outlet	Tripp-Lite	PDUMV20	2	\$161.27	\$322.54	\$415.54	
				Sub-Total	\$4,403.79	\$5,984.79	
UPS							
Online UPS 2200 Rack Mount	Tripp-Lite	SU2200RTXL2Ua	2	\$1,240.50	\$2,481.00	\$2,760.00	
Web Management Accessory Card	Tripp-Lite	WEBCARDLX	2	\$292.85	\$585.70	\$601.20	
				Sub-Total	\$3,066.70	\$3,361.20	
CABLING, PATCH PANELS, CABLE MANAGEMENT							
Cabling							
CAT6A Blue Plenum Cable	Berk-Tek	10130484	10000	\$0.65	\$6,500.00	\$9,910.00	
48 Port High Density Unloaded Patch Panel w/Wire Management	Leviton	49255-H48	1	\$48.75	\$48.75	\$72.00	
24 Port High Density Unloaded Patch Panel	Leviton	49255-H24	2	\$62.50	\$125.00	\$171.50	
CAT6A Insert, Blue	Leviton	6AUJK-RL6	91	\$13.75	\$1,251.25	\$2,379.65	
CAT6A Insert, Orange	Leviton	6110G-RO6	40	\$13.75	\$550.00	\$1,046.00	
CAT6A Insert, Black	Leviton	6AUJK-RE6	30	\$13.75	\$412.50	\$784.50	
4 Port Faceplate Ivory	Leviton	41080-4IP	7	\$1.57	\$10.99	\$65.24	
2 Port Faceplate Ivory	Leviton	41080-2IP	13	\$1.57	\$20.41	\$121.16	
2 Port Surface Mount Box Ivory	Leviton	41089-2IP	10	\$2.07	\$20.70	\$253.20	
Blank Insert Ivory	Leviton	41084-BIB	10	\$0.19	\$1.90	\$17.40	
Cable Support	VectorUSA		100	\$6.25	\$625.00	\$2,175.00	
Cable Management							
1U Horizontal Wire Manager	Leviton	491RU-HFR	1	\$43.75	\$43.75	\$67.00	
2 Rack Unit Horizontal Cable Management - 3IN x 3IN Front and	Leviton	492RU-HFR	4	\$46.25	\$185.00	\$278.00	
Testing							
Testing & Labeling - Copper	VectorUSA		52	\$0.63	\$32.76	\$677.56	
Demo							
Demo old Cable	VectorUSA		1			\$4,464.00	
				Sub-Total	\$9,828.01	\$22,482.21	
INDOOR CONDUITS, DUCTS, CABLE LADDERS, CORE DRILLING							
Cores & Sleeve				\$93.75	\$281.25	\$839.25	
				Sub-Total	\$281.25	\$839.25	
SYSTEM ORIENTATION AND DOCUMENTATION							
CAD							
CAD Documentation			1	\$0.00	\$600.00	\$600.00	
System Orientation							
Mobilization & Logistics	VectorUSA		2	\$0.00	\$0.00	\$360.00	
Project Management	VectorUSA		1	\$0.00	\$0.00	\$4,400.00	
Discovery	VectorUSA		1	\$0.00	\$0.00	\$2,000.00	
Site Survey	VectorUSA		1	\$0.00	\$0.00	\$744.00	
				Sub-Total	\$600.00	\$8,104.00	
BASIC OAM TRAINING							
Training			1	\$0.00	\$1,000.00	\$1,000.00	
				Sub-Total	\$1,000.00	\$1,000.00	
				PROJECT SUB-TOTAL		\$95,456.02	
				SALES TAX		\$3,898.78	
				PROJECT TOTAL		\$99,354.80	



PRICING SUMMARY

4 23/01/2012 10:00:00 AM

Data Network Equipment				
	Materials	Labor	Maintenance	Total
Network devices, systems, components	\$ 10,372.61	\$ 1,394.33	\$ -	\$ 11,766.94
WLAN controllers, Access Points, Antennas	\$ 5,070.76	\$ 1,581.00	\$ -	\$ 6,651.76
Network servers & core network services	\$ 11,425.90	\$ 6,010.42	\$ 3,224.98	\$ 20,661.30
Network Management Software	\$ 1,202.40	\$ 3,625.00	\$ -	\$ 4,827.40
Patch cabling & connectors	\$ 664.12	\$ 427.80	\$ -	\$ 1,091.92
Other (add description)	\$ -	\$ -	\$ -	\$ -
Subtotal	\$ 28,735.79	\$ 13,038.55	\$ 3,224.98	\$ 44,999.32

Building & Facilities (Infrastructure)				
	Materials	Labor	Maintenance	Total
Commercial electric service	\$ -	\$ -	\$ -	\$ -
HVAC, environmental monitoring	\$ 316.67	\$ 108.50	\$ -	\$ 425.17
Indoor electrical upgrade	\$ 1,652.08	\$ 6,608.00	\$ -	\$ 8,260.08
Racks, cabinets, cable management, PDU's	\$ 4,403.79	\$ 1,581.00	\$ -	\$ 5,984.79
UPS	\$ 3,066.70	\$ 294.50	\$ -	\$ 3,361.20
Other (add description)	\$ -	\$ -	\$ -	\$ -
Subtotal	\$ 9,439.24	\$ 8,592.00	\$ -	\$ 18,031.24

Inside Wiring			
	Materials	Labor	Total
Cabling, patch panels, cable management	\$ 9,828.01	\$ 12,654.20	\$ 22,482.21
Indoor conduits, ducts, cable ladders, core drilling	\$ 281.25	\$ 558.00	\$ 839.25
Other (add description)	\$ -	\$ -	\$ -
Subtotal	\$ 10,109.26	\$ 13,212.20	\$ 23,321.46

Technical Network Training			
	Hours	Rate	Total
System orientation and documentation	\$ 64.00	\$ 126.63	\$ 8,104.00
Basic OAM training	\$ 8.00	\$ 125.00	\$ 1,000.00
Subtotal	\$ 72.00	\$ 251.63	\$ 9,104.00
Tax			\$ 3,898.78
Grand Total:			\$ 99,354.80

LOGICAL DRAWINGS

BANNING LIBRARY

Main Electrical Room

PARKING LOT

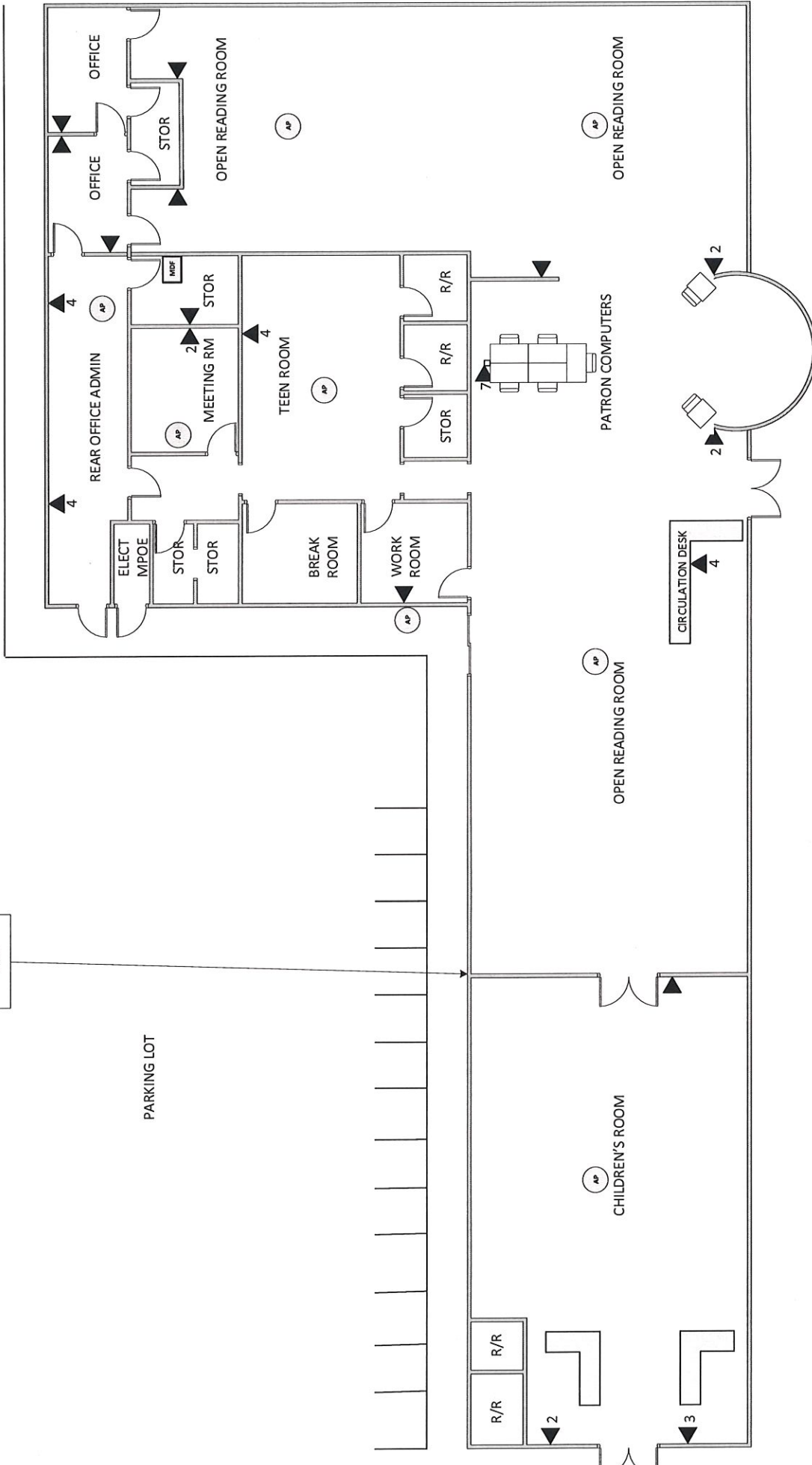

Schematic diagram of proposed network systems and connections

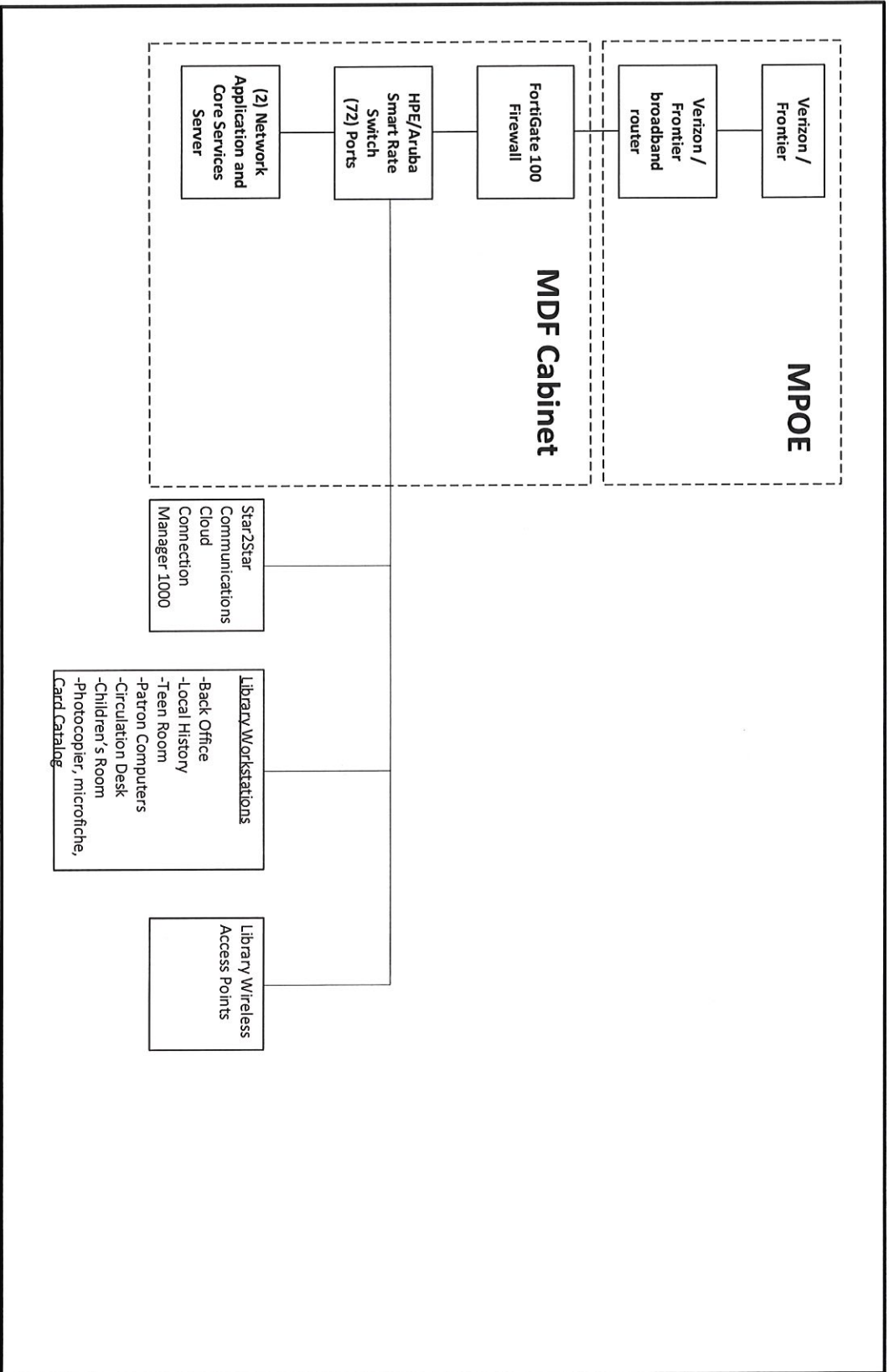

Chatsworth Products Cabinet Layout

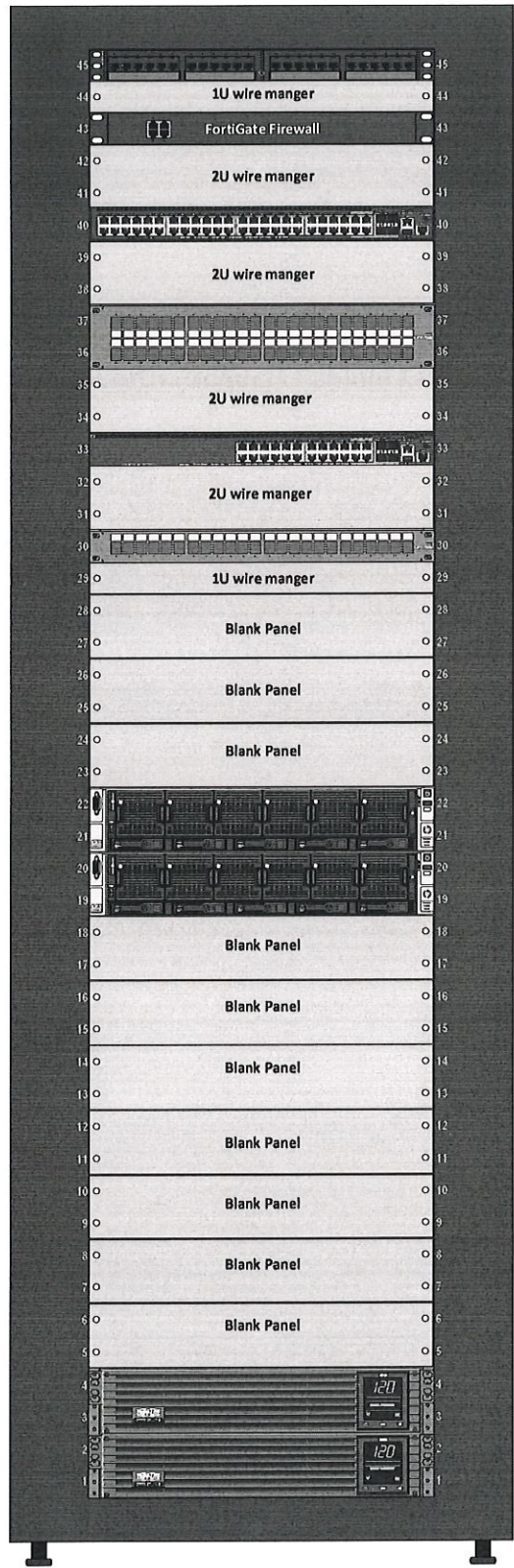

THIS DRAWING CONTAINS PROPRIETARY AND CONFIDENTIAL INFORMATION AND IS PROTECTED BY U.S. AND INTERNATIONAL LAW. UNAUTHORIZED REPRODUCTION, DISCLOSURE OR USE OF THE DRAWING OR THE INFORMATION THEREIN IS EXPRESSLY FORBIDDEN. EXCEPT AS AGREED TO IN WRITING BY CHATSWORTH PRODUCTS, INC.

CONFIDENTIAL AND PROPRIETARY

REVISION

ISS	DESCRIPTION	DATE	APPROVED
			CHK ENG

QUOTE DESCRIPTION:

- FRAME, 6 SLIDEX45UX700WX1200D
- BLACK
- SQUARE PUNCHED RAILS WITH 4X CABLE PORT OPENINGS -INCLUDES RAIL GROMMET KIT (1)
- STANDARD CASTER AND LEVELER KIT
- GLOBALFRAME PERF METAL CURVED DOOR -INSTALL FRONT
- SINGLE POINT KEYED LOCK -INSTALL FRONT
- DOUBLE PERFORATED METAL FLAT DOOR -INSTALL REAR
- THREE POINT KEYED LOCK -INSTALL REAR
- STANDARD SOLID SIDE PANEL -INSTALL LEFT
- STANDARD SOLID SIDE PANEL -INSTALL RIGHT
- ADJUSTABLE AIR DAM KIT FOR USE WITHOUT FULL-DEPTH BOTTOM PANEL
- VERTICAL EXHAUST DUCT 20-34IN HEIGHT WITH BRUSH
- TOP PANEL FOR VED USE WITH 2X BRUSHES
- (3) SHORT FINGER MANAGER WITH DOOR -INSTALL: FRONT LEFT RAIL-FRONT RIGHT RAIL-REAR RIGHT RAIL
- (1) CABLE LASHING BRACKET WITH OBROUND SLOTS, 2.5IN WIDE -INSTALL: REAR LEFT
- (2) CABLE LASHING BRACKET WITH MUSHROOM SLOTS, 5.1IN WIDE -INSTALL: FRONT LEFT-FRONT RIGHT
- (1) STANDARD DUAL TWO PIECE PDU BRACKET, 3.9 IN WIDE
- COMMON PARTS KIT, GF, NON-UJ
- PACKAGING KIT

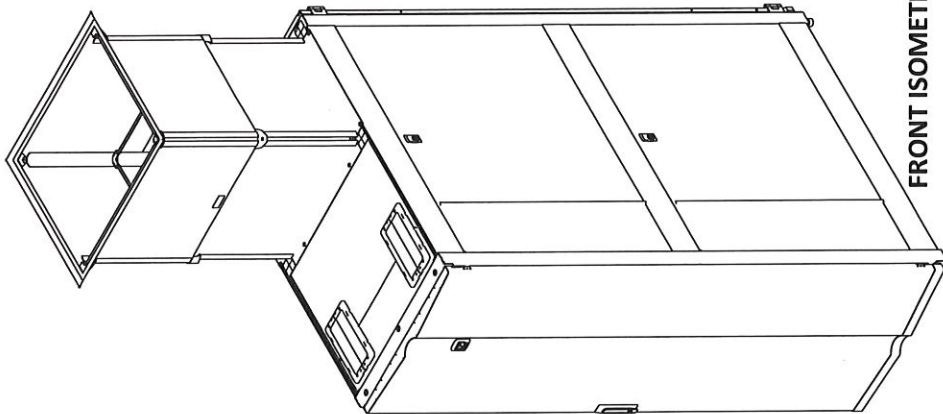

FRONT ISOMETRIC VIEW

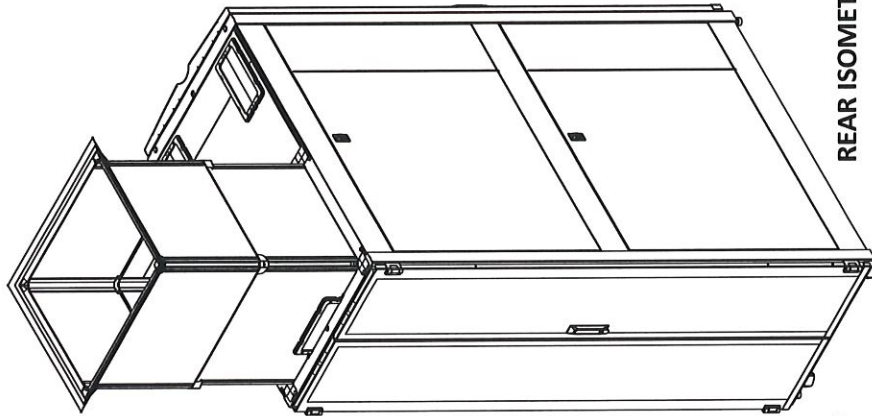

REAR ISOMETRIC VIEW

SEE SHEET 2 & 3 FOR ADDITIONAL DRAWING VIEWS

- NOTES:
1. THIS DRAWING GENERATED PER SELECTIONS MADE THROUGH CPI LIVE CONFIGURATOR
 2. ENGINEERING DOCUMENTATION REVIEWED UPON RECEIPT OF ORDER
 3. DRAWING IMAGES IN THIS PACKAGE ARE CONCEPTUAL AND ARE NOT EXPECTED TO PROVIDE AN EXACT REPRESENTATION OF THE COMPLETED CPI PRODUCT
 4. WHILE EVERY EFFORT HAS BEEN MADE TO ENSURE THE ACCURACY OF THE PRODUCTS CPI DOES NOT ACCEPT LIABILITY FOR ANY ERRORS OR OMISSIONS AND RESERVES THE RIGHT TO CHANGE INFORMATION AND DESCRIPTIONS OF LISTED SERVICES AND PRODUCTS

UNLESS OTHERWISE SPECIFIED ALL DIMENSIONS SHOWN ARE IN MILLIMETERS ARE REFERENCE ONLY		APPROVALS	DATE
SPECIFIED TOLERANCES ON:			
.XX(X)	ANGLE	DR:	
±.03(±0.6)	±.01(±0.25)	CHK:	
THIRD ANGLE		MECH ENG:	
ITEM TO CONFORM TO DFC-754002 CORPORATE COSMETIC SPEC		ELEC ENG:	
MATERIAL		FINISH	
CPI CHATSWORTH PRODUCTS, INC.		DWG NO	ISS
GF,6SL,BK		C	MIS-TS1520100
700WX1200DX45U		SCALE:1:2.8571	SHEET 1 OF 3
SQ,PM/DPM			

THIS DRAWING CONTAINS PROPRIETARY AND CONFIDENTIAL INFORMATION AND IS PROTECTED BY U.S. AND INTERNATIONAL LAW. UNAUTHORIZED REPRODUCTION, DISCLOSURE OR USE OF THE DRAWING IS STRICTLY PROHIBITED. CONTACT CHATSWORTH PRODUCTS, INC. FOR PERMISSION TO REPRODUCE OR USE THIS DRAWING, EXCEPT AS AGREED TO IN WRITING BY CHATSWORTH PRODUCTS, INC.

CONFIDENTIAL AND PROPRIETARY

TOP VIEW

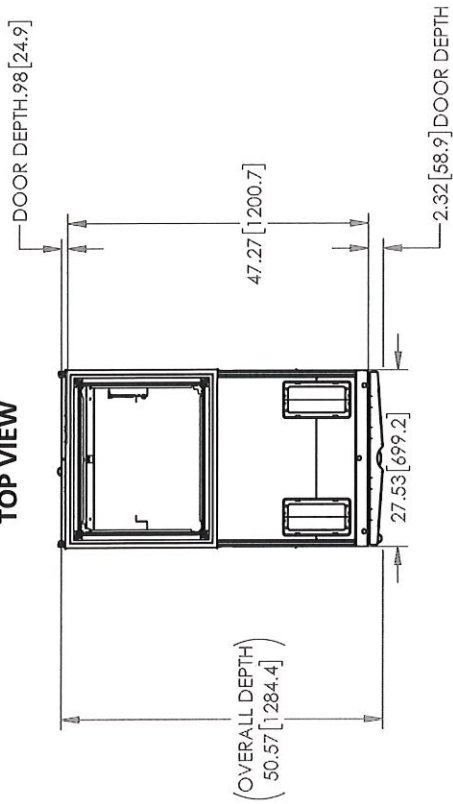

REVISION

ISS	DESCRIPTION	DATE	APPROVED
SEE SHEET 1			CHK ENG

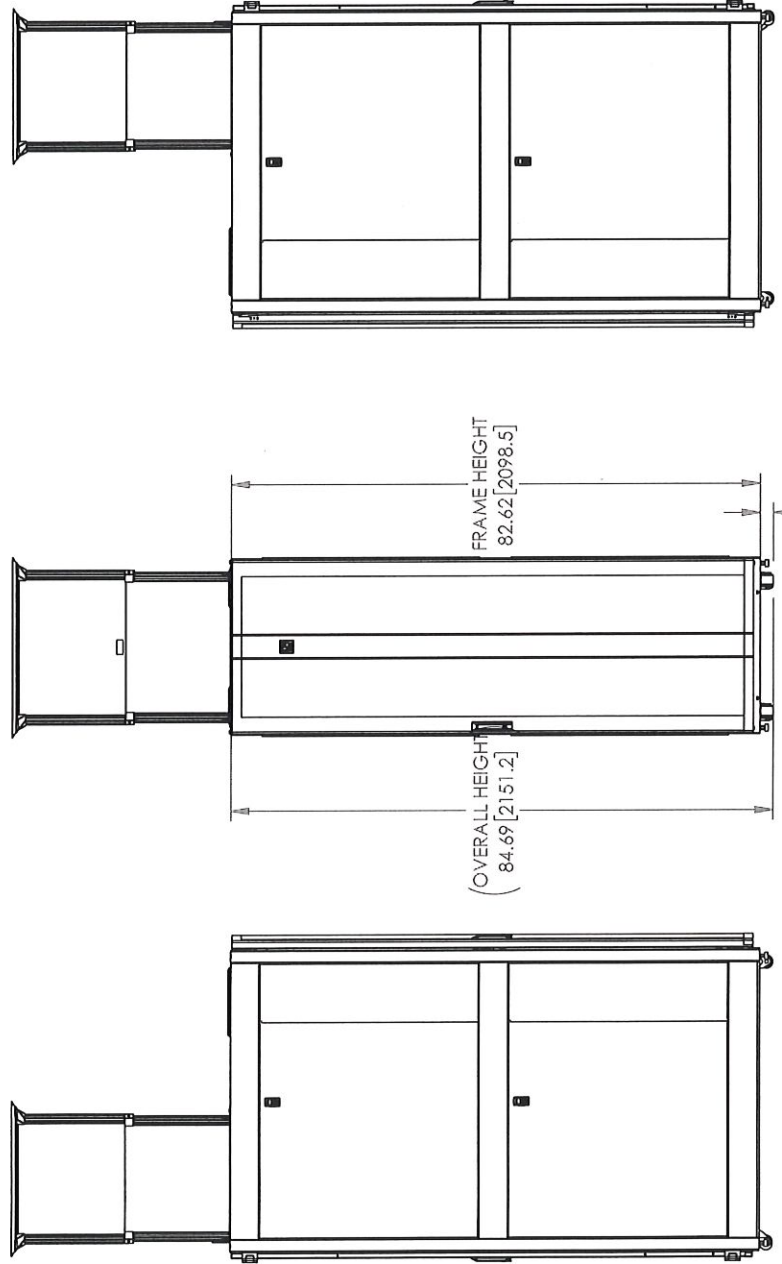

LEFT VIEW

FRONT VIEW

RIGHT VIEW



GF,6SL,BK
700Wx1200Dx45U
SQ,PM/DPM

DWG SIE	C	MIS-TS1520100	SHEET	2	OF	3
SCALE	1:15					

ISS

THIS DRAWING CONTAINS PROPRIETARY AND CONFIDENTIAL INFORMATION AND IS PROTECTED BY U.S. AND INTERNATIONAL PATENT LAWS. ANY UNAUTHORIZED DISCLOSURE OR USE OF THE DRAWING OR THE INFORMATION CONTAINED HEREIN WITHOUT THE WRITTEN PERMISSION OF CHATSWORTH PRODUCTS, INC. IS STRICTLY PROHIBITED.

CONFIDENTIAL AND PROPRIETARY

SECTION A-A

TOP VIEW

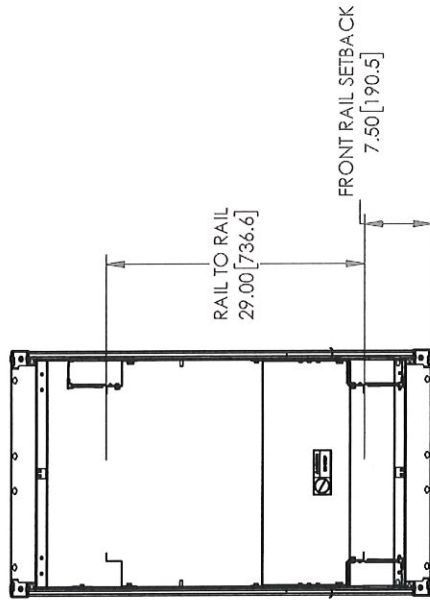

REVISION		DATE	APPROVED
ISS	DESCRIPTION		CHK
	SEE SHEET 1		ENG

INTERNAL VIEW:
AS APPROPRIATE DOORS, LOCKS, TOP
PANELS, VEDS, BOTTOM PANELS, AND
SIDE PANELS
HIDDEN FOR CLARITY

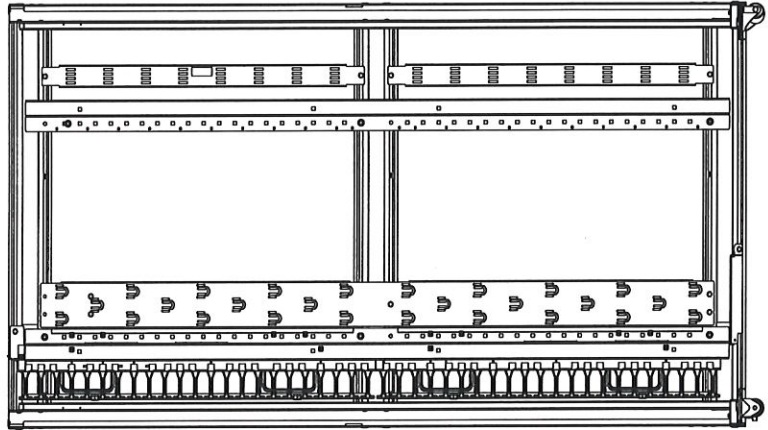
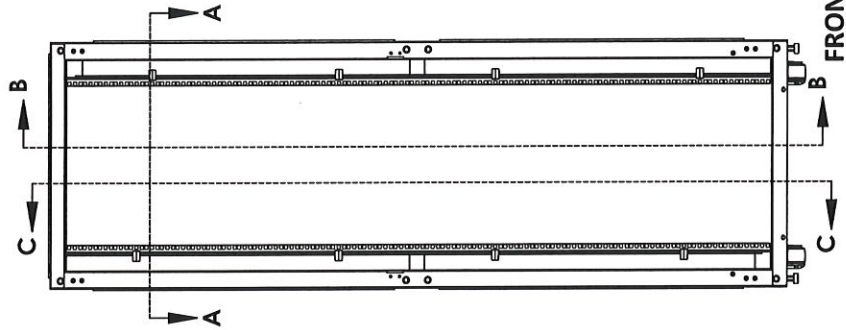
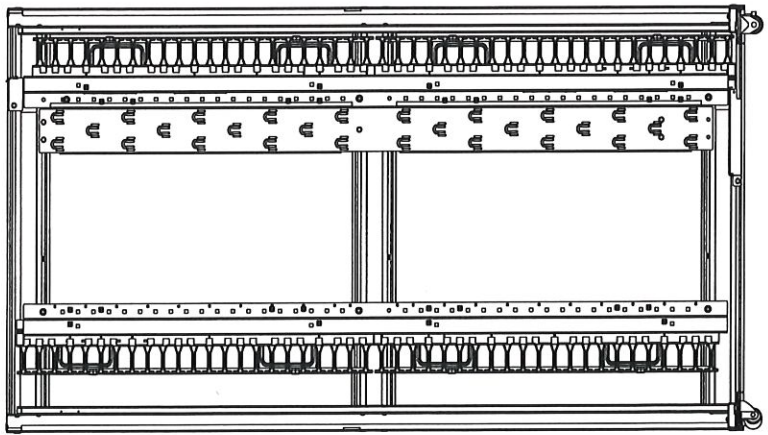

SECTION B-B

SECTION C-C

SECTION C-C

CPI CHATSWORTH PRODUCTS, INC.

GF,6SL,BK
700Wx1200Dx45U
SQ,PM/DPM

DWG NO. **C** MIS-TS1520100
SCALE: 1:10.7143 SHEET 3 OF 3